

**6 Series**

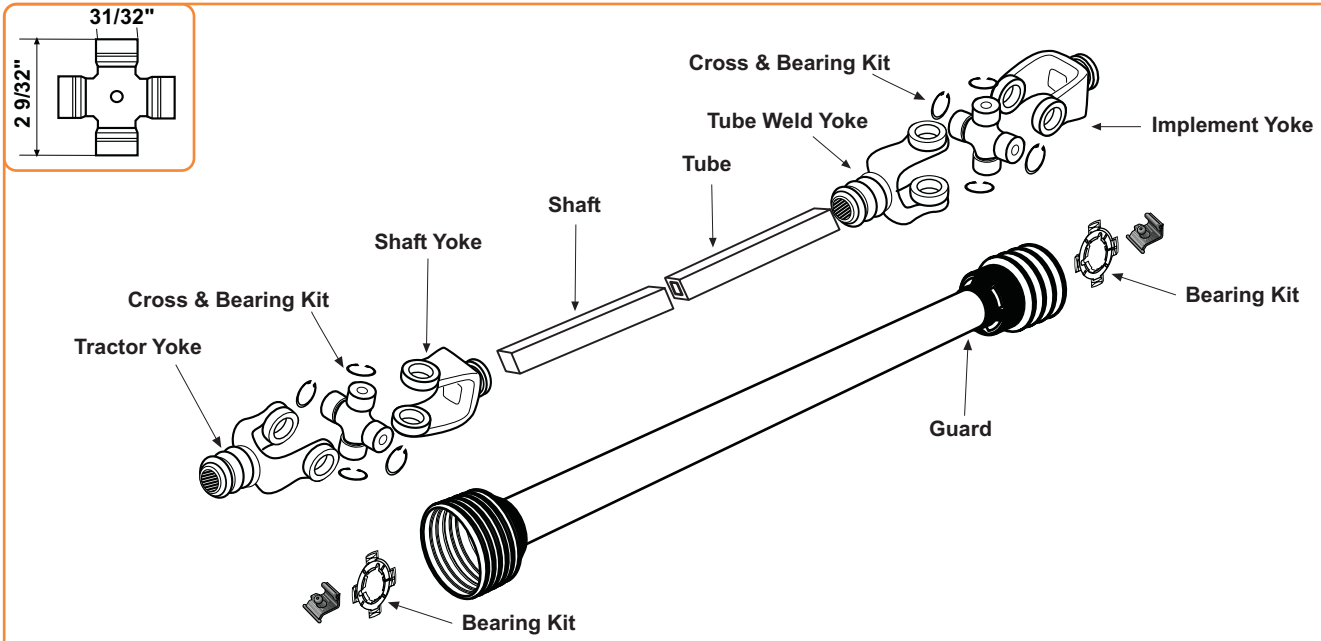

**Tractor Yoke**



Stock Number	A Bore	Spline
S.100-0606	1 3/8"	6 Spring-Lok
S.100-0621	1 3/8"	21 Spring-Lok
S.301-0600	1"	15 Auto-Lok

**Tractor Yoke  
Lawn & Garden**

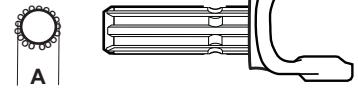

Stock Number	A Bore	Male Spline
S.106-0615	1"	15

**Tractor Yoke  
Quick Disconnect**

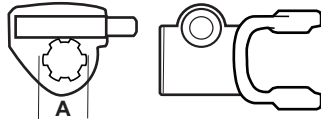

Stock Number	A Bore	Spline
S.102-0606	1 3/8"	6
S.102-0621	1 3/8"	21

**Cross & Bearing Kit  
Internal Lock**

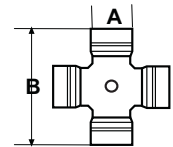

Stock Number	A	B
S.200-0600	31/32"	2 9/32"

**Tractor Yoke  
Lawn & Garden**

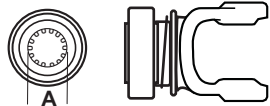

Stock Number	A Bore	Spline
S.105-0615	1"	15 Spring Lok
S.101-0615	1"	15 Auto Lok

**Shaft Weld Yoke  
With Bearing Groove**

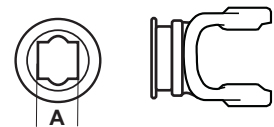

Stock Number	A Bore
S.300-0600	3/4" x 7/8"

6 Series

Shaft



Stock Number	Length	Diameter
S.400-1214	6'	3/4 x 7/8
S.404-1214	3'	3/4 x 7/8
S.404-1615H	3'	1 x 15 Spline

Slip Sleeve With Grease Groove

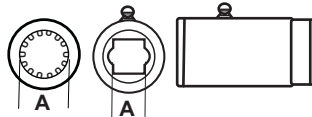

Stock Number	A Bore	Fits Tube Size
S.510-0600	3/4" x 7/8"	1 1/2" (.065 Wall)
S.510-0615	1" x 15 Spline	1 1/2" (.065 Wall)

Tube 1" x 1 1/8" OD



Stock Number	Length	Fits Shaft
S.600-1618	6'	3/4" x 7/8"
S.604-1618	3'	3/4" x 7/8"

Tube 1 1/2" Round OD (.065 Wall)



Stock Number	Length
S.602-0600	6'

Tube Weld Yoke With Bearing Groove



Stock Number	A Bore	B Bore	Fits Tube Size
S.700-0600	1" x 1 1/8"		
S.701-0600		1"	1 1/2" (.065 Wall)
S.702-0600* (*less Bearing Groove)		Solid	1 1/2" (.065 Wall)

Implement Yoke - Round/Hexagon Bore with Keyway & Set Screw

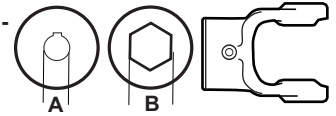

Stock Number	A Bore	B Bore	Standard Keyway
S.800-0610	5/8"	-	3/16"
S.800-0612	3/4"	-	3/16"
S.800-0613	13/16"	-	3/16"
S.800-0614	7/8"	-	3/16"
S.800-0615	15/16"	-	1/4"
S.800-0616	1"	-	1/4"
S.800-0618	1 1/8"	-	1/4"
S.800-0619	1 3/16"	-	1/4"
S.800-0620	1 1/4"	-	1/4"
S.15-5172	-	1 1/8"	-

Spline Bore With 1/4" Pin Hole

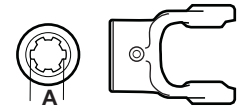

Stock Number	A Bore	Spline
S.801-0606	1 3/8"	6
S.801-0618	1 1/8"	6

Shear Pin With 1/4" Pin Hole

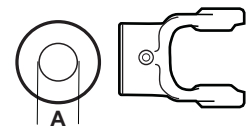

Stock Number	A Bore
S.802-0616	1"
S.802-0618	1 1/8"
S.802-0620	1 1/4"

Square Bore With Set Screw

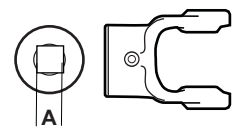

Stock Number	A Bore
S.804-0612	3/4"
S.804-0614	7/8"
S.804-0616	1"
S.804-0618	1 1/8"
S.804-0620	1 1/4"

**6 Series**

**Round Bore - Double Keyway & Set Screw**

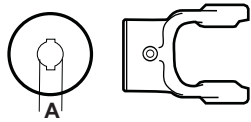

Stock Number	A Bore	Double Keyway
S.806-0612	3/4"	3/16" & 1/4"
S.806-0613	13/16"	3/16" & 1/4"
S.806-0614	7/8"	3/16" & 1/4"
S.806-0616	1"	3/16" & 1/4"
S.806-0618	1 1/8"	1/4" & 5/16"
S.806-0620	1 1/4"	1/4" & 5/16"

**Yoke & Shaft Assembly**

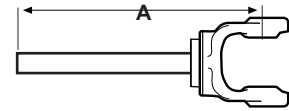

Stock Number	Shaft Size	Spline	A Length
S.10000610	1"	15	12 1/2"
S.10000648	3/4" x 7/8"		39"

**Clamp Yoke With Bolt Hole & Set Screw**

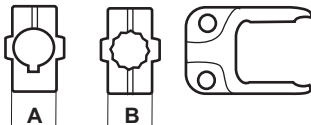

Stock Number	A Bore	B Bore	Keyway	Spline
S.807-0615		1"		15
S.807-0616	1"		1/4"	

**Yoke & Tube Assembly  
1" x 1 1/8" Tube**

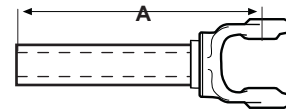

Stock Number	Fits Shaft	A Length
S.11000648	3/4" x 7/8"	38 3/4"

**Slip Sleeve Yoke**

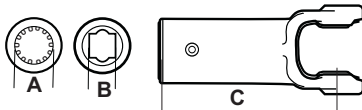

Stock Number	A Bore	B Bore	C Length
S.808-0612		3/4" Sq.	5 1/2"
S.808-0614		7/8" Sq.	5 1/2"
S.812-0615	1" x 15 Spline		
S.813-0600		3/4" x 7/8"	5 1/2"

**Universal Joint - Spring Lok to Shaft Weld Yoke**

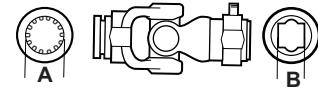

Stock Number	A Bore	B Bore
S.15060600	1 3/8" x 6	3/4" x 7/8"

**Universal Joint - Tube Weld Yoke to Implement Yoke - Round Bore Furnished with Keyway & Set Screw**

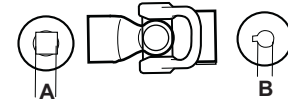

Stock Number	A Bore	B Bore
S.15000616	1" x 1 1/8"	1"

**Guard - 250 Plastic**

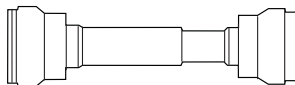

Stock Number	Overall Length
S.59605	29 1/2"
S.59606	39 1/2"
S.59607	51 1/2"

**Bearing Kit - 250**

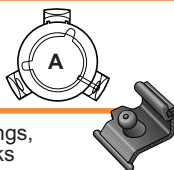

Stock Number	Kit Contains
S.22566	2 x A=46.4mm ID Bearings, 2 x S.56509 Nipple Locks

**Universal Joint - Round To Round Furnished with Keyway & Set Screw**

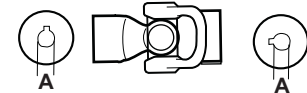

Stock Number	A Bore
S.15120612	3/4"
S.15160616	1"

6 Series

Driveline

Driveline is furnished without Cross & Bearing Kit and Implement Yoke. Select kit and Implement Yoke as required. When Cross & Bearing Kit and Implement Yoke are assembled, the overall compressed length of the driveline will be 48".

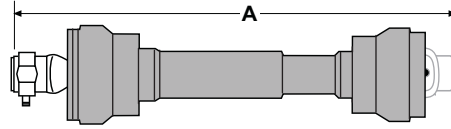

Stock Number	Tractor Yoke	A Length
S.14000648	1 3/8" x 6 Spl. Spring Lok	48"

Driveline

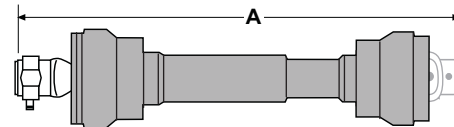

Stock Number	Tractor Yoke	Implement Yoke	A Length
S.14000600	1 3/8" x 6 Spl. Spring Lok	1" Round with Pin Hole	39"

**12 Series**

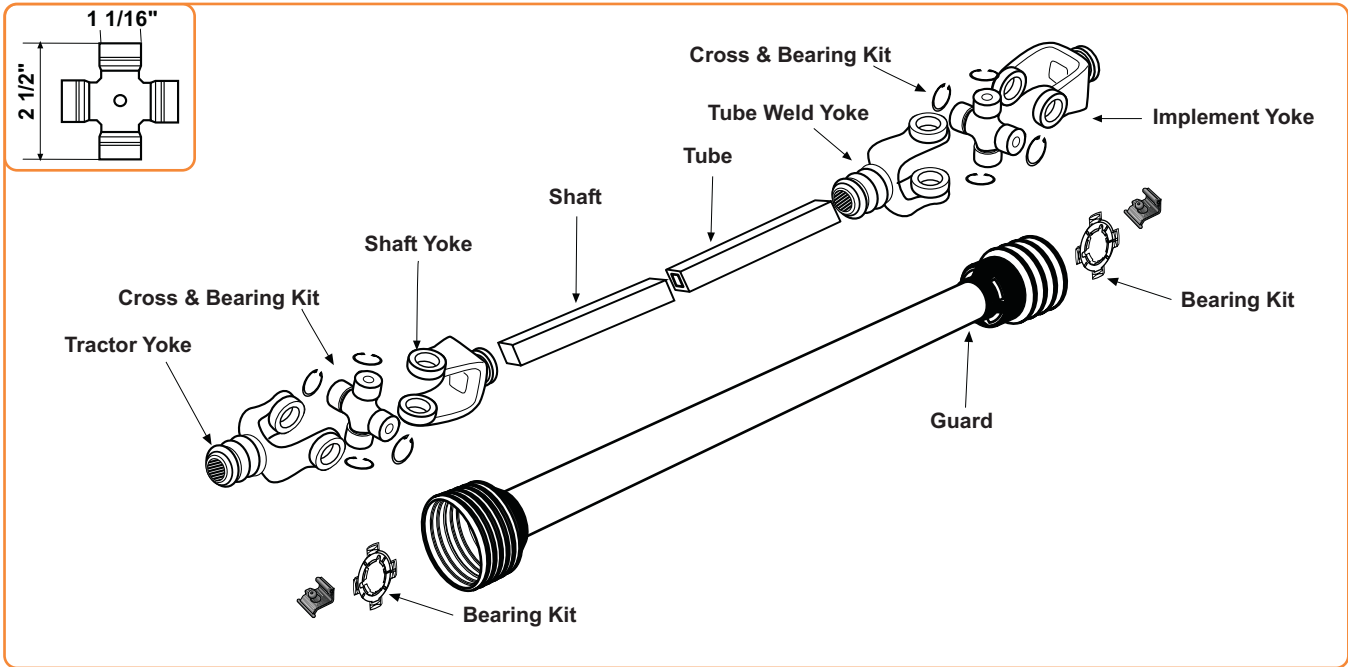

**Tractor Yoke  
Spring-Lok**

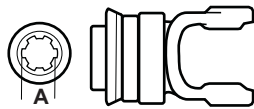

Stock Number	A Bore	Spline
S.100-1206	1 3/8"	6
S.100-1221	1 3/8"	21

**Cross & Bearing Kit  
Internal Lock**

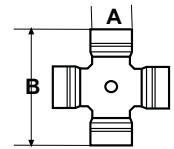

Stock Number	A	B
S.200-1200	1 1/16"	2 1/2"

**Tractor Yoke  
Quick Disconnect**

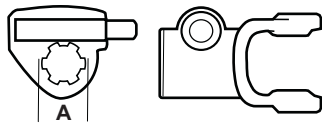

Stock Number	A Bore	Spline
S.102-1206	1 3/8"	6
S.102-1221	1 3/8"	21

**Shaft Weld Yoke  
With Bearing Groove**

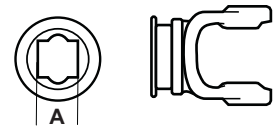

Stock Number	A Bore
S.300-1200	1" x 1 1/8"

**Ball Shear Device  
With Spring-Lok**

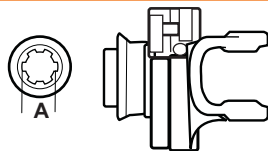

Stock Number	A Bore	Spline	Shear Bolt
S.104-1206	1 3/8"	6	5/16" - 18 Gr. 5
S.104-1221	1 3/8"	21	5/16" - 18 Gr. 5

**Shaft  
1" x 1 1/8"  
Rectangular**

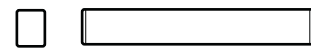

Stock Number	Length
S.400-1618	6'

12 Series

**Slip Sleeve  
With Grease Groove**

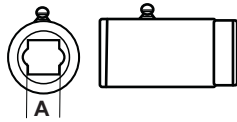

Stock Number	A Bore	Length	Fits Tube Size
S.500-1400	1" x 1 1/8" Rect.	5"	2" (.083 Wall)
S.501-1400	1 5/16" x 20 Spl.	8"	2" (.083 Wall)

**Implement Yoke -  
Round Bore  
With Keyway &  
Set Screw**

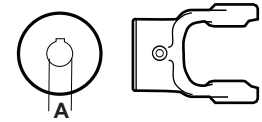

Stock Number	A Bore	Standard Keyway
S.800-1212	3/4"	3/16"
S.800-1214	7/8"	3/16"
S.800-1215	15/16"	1/4"
S.800-1216	1"	1/4"
S.800-1218	1 1/8"	1/4"
S.800-1219	1 3/16"	1/4"
S.800-1220	1 1/4"	1/4"
S.800-1222	1 3/8"	5/16"
S.800-1224	1 1/2"	3/8"

**Tube  
1 1/4" x 1 3/8"  
Rectangular OD**



Stock Number	Length	Fits Shaft
S.600-2022	6'	1" x 1 1/8"

**Tube  
2" Round**

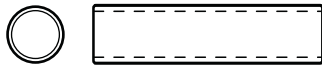

Stock Number	Length
S.602-1400	6'

**Spline Bore  
With 21/64" Pin Hole**

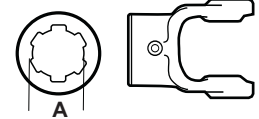

Stock Number	A Bore	Spline
S.801-1206	1 3/8"	6
S.801-1210*	1 3/16"	10 *No Pin Hole
S.801-1218	1 1/8"	6
S.801-1221	1 3/8"	21

**Tube Weld Yoke  
With Bearing Groove**



Stock Number	A Bore	Fits Tube Size
S.700-1200	1 1/4" x 1 3/8"	
S.701-1200		2" (.083 Wall)

**Shear Pin  
With 1/4" Pin Hole**

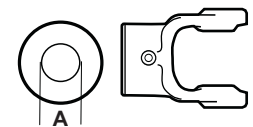

Stock Number	A Bore
S.802-1216	1"
S.802-1218	1 1/8"
S.802-1220	1 1/4"
S.802-1222	1 3/8"

**Hexagon Bore  
With Set Screw**

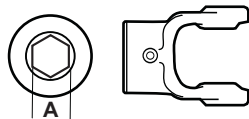

Stock Number	A Bore
S.805-1218	1 1/8"

**Square Bore  
With Set Screw**

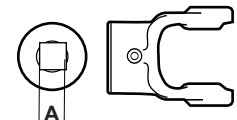

Stock Number	A Bore
S.804-1214	7/8"
S.804-1216	1"
S.804-1218	1 1/8"
S.804-1220	1 1/4"

**12 Series**

**Round Bore  
Double Keyway &  
Set Screw**

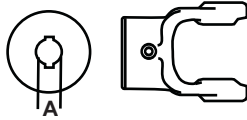

Stock Number	A Bore	Double Keyway
S.806-1216	1"	1/4" & 3/16"
S.806-1218	1 1/8"	1/4" & 5/16"
S.806-1220	1 1/4"	1/4" & 5/16"

**Universal Joint -  
Tube Weld Yoke to  
Implement Yoke -  
Round Bore Furnished  
with Keyway & Set Screw**

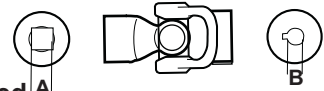

Stock Number	A Bore	B Bore
S.15001216	1 1/4" x 1 3/8"	1"
S.15001218	1 1/4" x 1 3/8"	1 1/8"
S.15001220	1 1/4" x 1 3/8"	1 1/4"

**Yoke & Shaft Assembly  
1" x 1 1/8" Shaft**

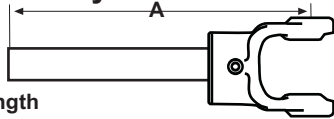

Stock Number	A Length
S.10001248	37 1/2"
S.10001260	49 1/2"

**Universal Joint - Round To Round  
Furnished with Keyway & Set Screw**

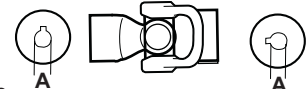

Stock Number	A Bore
S.15161216	1"
S.15201220	1 1/4"

**Yoke & Tube Assembly  
1 1/4" x 1 3/8" Tube**

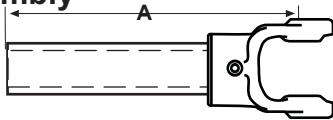

Stock Number	A Length	Fits Shaft
S.11001248	37 1/2"	1" x 1 1/8"
S.11001260	49 1/2"	1" x 1 1/8"

**Bearing Kit - 250**

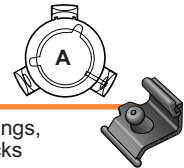

Stock Number	Kit Contains
S.22567	2 x A=52.8mm ID Bearings, 2 x S.56509 Nipple Locks

**Driveline**

Driveline is furnished without Cross & Bearing Kit and Implement Yoke. Select kit and Implement Yoke as required. When Cross & Bearing Kit and Implement Yoke are assembled, the overall compressed length of the driveline will be 48".

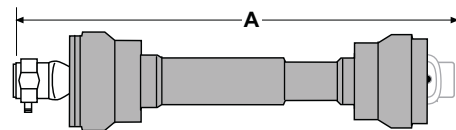

Stock Number	Tractor Yoke	Implement Yoke	A Length
S.14001248	1 3/8" x 6 Spl. Spring Lok	-	48"
S.14001220	1 3/8" x 6 Spl. Spring Lok	1 1/4" Round with 1/4" Keyway	48"

**Guard - 250**

Stock Number	A Length
S.59605	29 1/2"
S.59606	39 1/2"
S.59607	51 1/2"

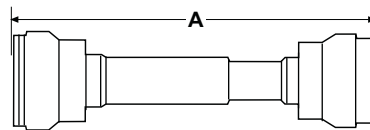

14 Series

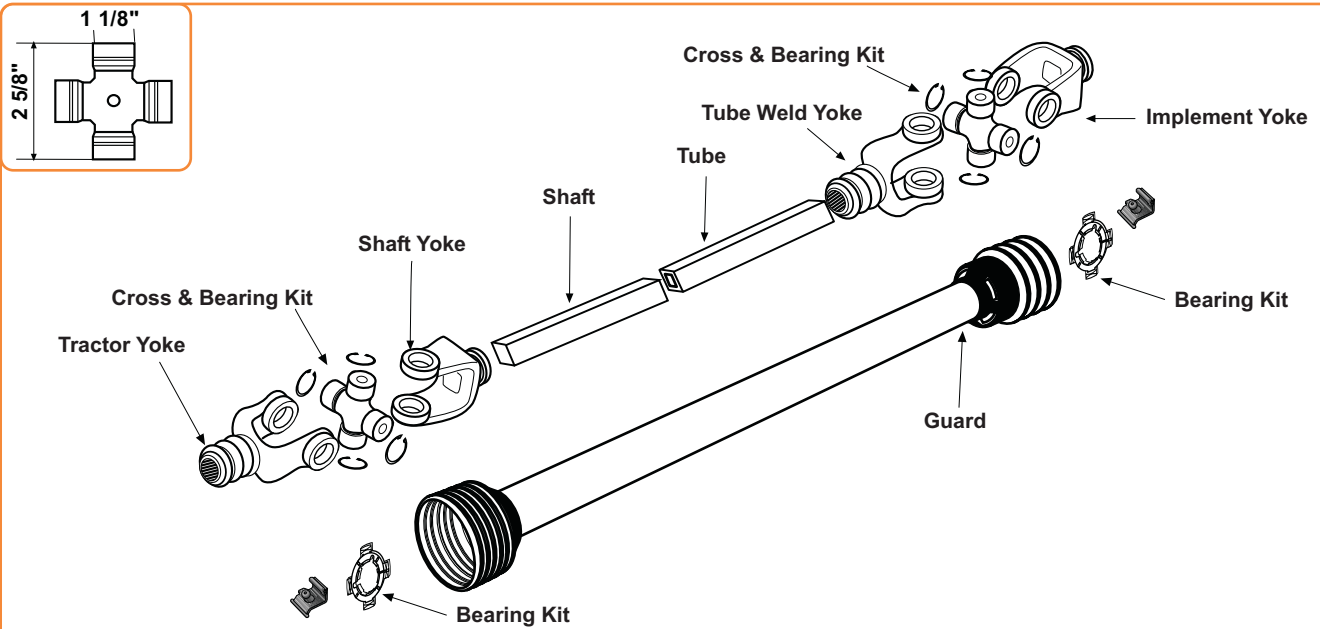

Tractor Yoke Spring-Lok

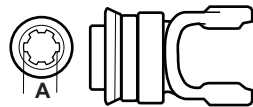

Stock Number	A Bore	Spline
S.100-1406	1 3/8"	6
S.100-1421	1 3/8"	21

Ball Shear Device With Spring-Lok



Stock Number	A Bore	Spline	Shear Bolt
S.104-1206	1 3/8"	6	5/16" - 18 Gr. 5
S.104-1221	1 3/8"	21	5/16" - 18 Gr. 5

Tractor Yoke Safety Slide Lock

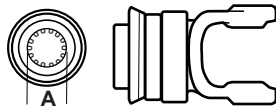

Stock Number	A Bore	Spline
S.101-1420	1 3/4"	20

Cross & Bearing Kit - Internal Lock

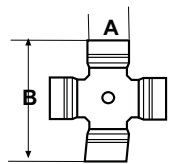

Stock Number	A	B
S.200-1400 (External)	1 1/8"	2 5/8"
S.61403 (Internal)		

Tractor Yoke Quick Disconnect

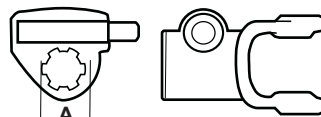

Stock Number	A Bore	Spline
S.102-1406	1 3/8"	6
S.102-1421	1 3/8"	21

Shaft Weld Yoke With Bearing Groove

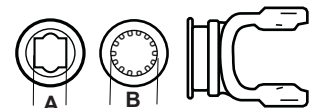

Stock Number	A Bore	B Bore	Spline
S.300-1400	1" x 1 1/8"		
S.301-1400		1 5/16"	20

**14 Series**

**Shaft -  
1" x 1 1/8"  
Rectangular**

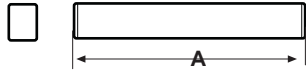

Stock Number	A Length
S.400-1618	6'

**Tube -  
2" Round**

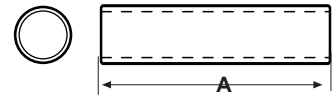

Stock Number	A Length	Fits Tube Size
S.602-1400	6'	2" (.083 Wall)

**Shaft -  
1 5/16" x 20 Spline**

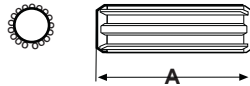

Stock Number	A Length
S.404-2120	3'

**Tube Weld Yoke -  
with Bearing Groove**

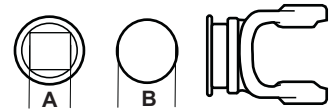

Stock Number	A Bore	Fits Tube Size B
S.700-1400	1 1/4" X 1 3/8"	2" (.083 Wall)
S.701-1400		

**Slip Sleeve -  
1" x 1 1/8" Rectangular  
with Grease Groove**

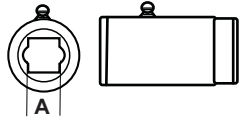

Stock Number	Length	Fits Tube Size
S.500-1400	5"	2" (.083 Wall)

**Implement Yoke -  
Round Bore  
With Keyway &  
Set Screw**

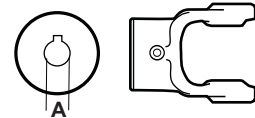

Stock Number	A Bore	Standard Keyway
S.800-1416	1"	1/4"
S.800-1418	1 1/8"	1/4"
S.800-1419	1 3/16"	1/4"
S.800-1420	1 1/4"	1/4"
S.800-1422	1 3/8"	5/16"
S.800-1423	1 7/16"	3/8"
S.800-1424	1 1/2"	3/8"

**Slip Sleeve -  
1 5/16" x 20 Spline**

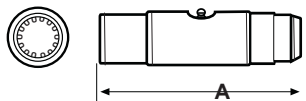

Stock Number	A Length	Fits Tube Size
S.501-1400	8"	2" (.083 Wall)

**Tube -  
1 1/4" x 1 3/8"  
Rectangular OD**

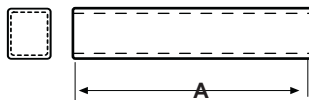

Stock Number	A Length	Fits Shaft
S.600-2022	6'	1" x 1 1/8"

**Spline Bore  
With 21/64" Pin Hole**

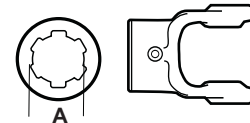

Stock Number	A Bore	Spline
S.801-1418	1 1/8"	6
S.801-1406	1 3/8"	6
S.801-1420	1 1/4"	6
S.801-1421	1 3/8"	21

14 Series

**Shear Pin With 1/4" Pin Hole**

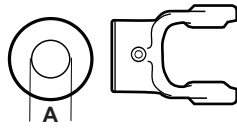

Stock Number	A Bore
S.802-1418	1 1/8"
S.802-1420	1 1/4"
S.802-1422*	1 3/8" (*1/4" & 1/2" Pin Hole)
S.802-1424	1 1/2"

**Guard - Plastic (Use Bearing Kit S.22567)**

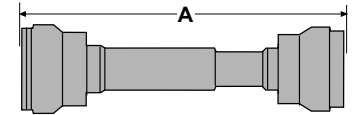

Stock Number	A Length
S.59605	29 1/2"
S.59606	39 1/2"
S.59607	51 1/2"

**Torque Limiter Flange**

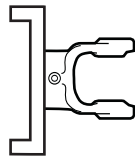

Stock Number
S.803-1400

**Guard - Metal With Bearing**

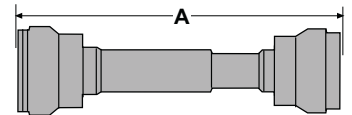

Stock Number	A Length
S.901-1272	72"

**Square Bore With Set Screw**

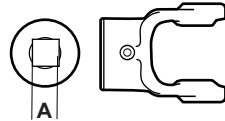

Stock Number	A Bore
S.804-1414	7/8"
S.804-1416	1"
S.804-1418	1 1/8"
S.804-1419	1 3/16"
S.804-1420	1 1/4"

**Bearing Kit - 250**

Stock Number	Kit Contains
S.22567	2 x A=52.8mm ID Bearings, 2 x S.56509 Nipple Locks

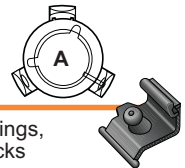

**Hexagon Bore With Set Screw**

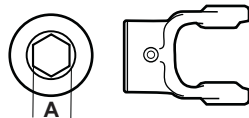

Stock Number	A Bore
S.805-1420	1 1/4"

**Yoke & Shaft Assembly 1" x 1 1/8" Shaft**

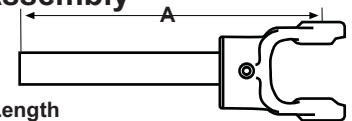

Stock Number	A Length
S.10001438	26 1/8"
S.10001448	35 5/8"
S.10001460	47 5/8"

**Round Bore Double Keyway & Set Screw**

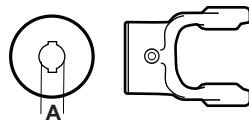

Stock Number	A Bore	Double Keyway
S.806-1418	1 1/8"	1/4" & 5/16"
S.806-1420	1 1/4"	1/4" & 5/16"

**Yoke & Tube Assembly 1" x 1 1/8" Rectangular**

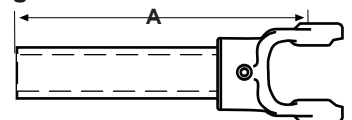

Stock Number	A Length
S.11001438	26 1/8"
S.11001448	35 1/8"
S.11001460	48 1/8"

**14 Series**

**Universal Joint - Spring Lok to Shaft Weld Yoke - Repair Kit**



Stock Number	A Bore	B Bore
S.15061400	1 3/8" x 6	1" x 1 1/8"

**Universal Joint - Tube Weld Yoke to Implement Yoke - Round Bore Furnished with Keyway & Set Screw**



Stock Number	A Bore	B Bore
S.15001418	2" (.083Wall)	1 1/8"

**Driveline**

Drivelines are furnished without Cross & Bearing Kit and Implement Yoke. Select kit and Implement Yoke as required. When Cross & Bearing Kit and Implement Yoke are assembled, the overall compressed length of the driveline will be 48".

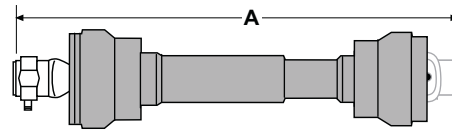

Stock Number	Tractor Yoke	A Length
S.14001448	1 3/8" x 6 Spl. Spring Lok	48"

**Driveline**

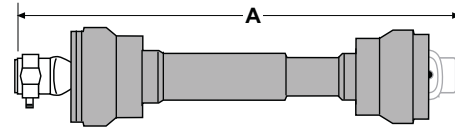

Stock Number	Tractor Yoke	Implement Yoke	A Length
S.14001404	1 3/8" x 6 Spl. Spring Lok	1 3/8" Round with 1/2" Pin Hole	30 3/16"
S.14001405	1 3/8" x 6 Spl. Spring Lok	1 3/8" Round with 1/2" Pin Hole	37 3/16"
S.14001406	1 3/8" x 6 Spl. Spring Lok	1 3/8" Round with 1/2" Pin Hole	56 3/16"
S.14001420	1 3/8" x 6 Spl. Spring Lok	1 1/4" Round with 1/4" Keyway	48"

Special Shaft No

**Special Shaft Record**

35 Series

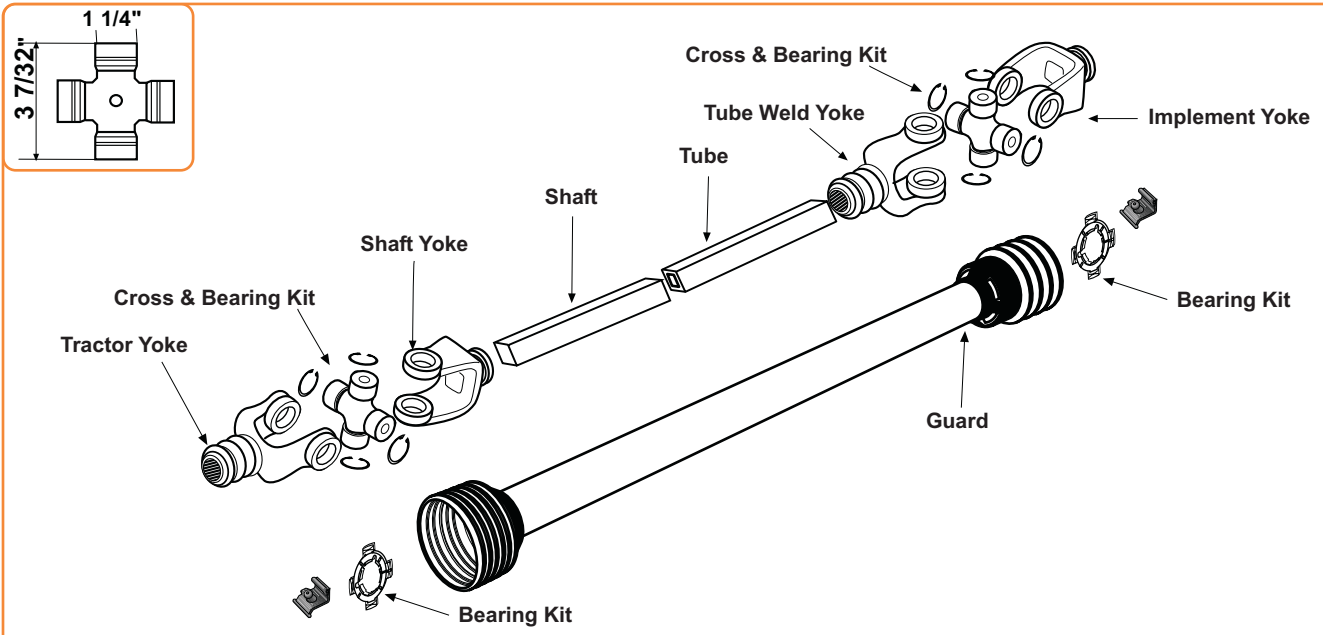

**Tractor Yoke Safety Slide Lock**

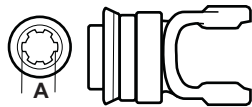

Stock Number	A Bore	Spline
S.101-3506	1 3/8"	6
S.101-3520	1 3/4"	20
S.101-3521	1 3/8"	21

**Cross & Bearing Kit -**

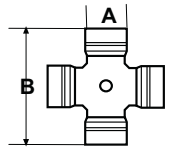

Stock Number	A	B
S.200-3500 (External)	1 1/4"	3 7/32"
S.61402 (Internal)		

**Tractor Yoke Quick Disconnect**

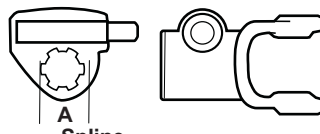

Stock Number	A Bore	Spline
S.102-3506	1 3/8"	6
S.102-3520	1 3/4"	20
S.102-3521	1 3/8"	21

**Shaft Weld Yoke With Bearing Groove**

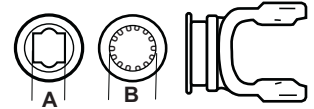

Stock Number	A Bore	B Bore	Spline
S.300-3500	1 3/16"		
S.301-3500		1 5/16"	20
S.302-3500		1 11/16"	20

**Ball Shear Device With Spring-Lok**

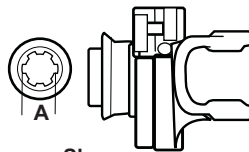

Stock Number	A Bore	Spline	Shear Bolt
S.104-3506	1 3/8"	6	3/8" - 16 Gr. 5
S.104-3521	1 3/8"	21	3/8" - 16 Gr. 5

**Shaft - 1 3/16" Square**

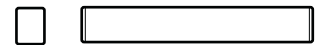

Stock Number	Length
S.400-0019	6'

**35 Series**

**Spline Shaft**

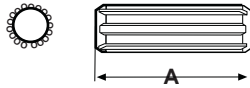

Stock Number	A Length	A Bore	Spline
S.404-2120	3'	1 5/16"	20
S.404-2720* (*Induction Hardened)	3'	1 11/16"	20

**Slip Sleeve -  
13/16" Square  
with Grease Groove**

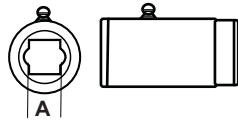

Stock Number	Length	Fits Tube Size
S.500-3500	5"	2 1/8" (.120 Wall)
S.501-3500	5"	2 1/8" (.083 Wall)

**Slip Sleeve -  
With Grease  
Reservoir**

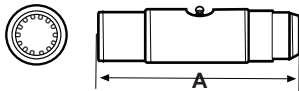

Stock Number	A Length	Bore	Spline	Fits Tube Size
S.502-3500	8"	1 5/16"	20	2 1/8" (.120 Wall)
S.503-3500	8"	1 11/16"	20	2 1/2" (.120 Wall)

**Tube**

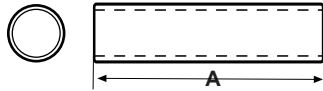

Stock Number	A Length	Fits Tube Size
S.602-3500	6'	2 1/8" (.120 Wall)
S.602-3501	6'	2 1/8" (.083 Wall)
S.70-2250	6'	2 1/4" (.120 Wall)

**Tube Weld Yoke -  
with Bearing Groove**



Stock Number	A Bore
S.701-3500	2 1/8" (.120 Wall)
S.702-3500	2 1/8" (.083 Wall)
S.703-3500	2 1/4" (.120 Wall)
S.704-3500* *(Use 44 Series Guard)	2 1/2" (.134 Wall)

**Implement Yoke -  
Round Bore  
With Keyway &  
Set Screw**

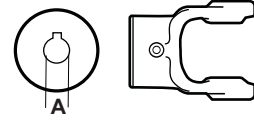

Stock Number	A Bore	Standard Keyway
S.800-3516	1"	1/4"
S.800-3518	1 1/8"	1/4"
S.800-3519	1 3/16"	1/4"
S.800-3520	1 1/4"	1/4"
S.800-3522	1 3/8"	5/16"
S.800-3523	1 7/16"	3/8"
S.800-3524	1 1/2"	3/8"
S.800-3526	1 5/8"	3/8"
S.800-3528	1 3/4"	3/8"

**Spline Bore -  
With 21/64" Pin Hole**

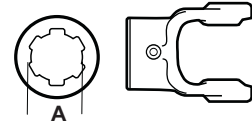

Stock Number	A Bore	Spline
S.801-3506	1 3/8"	6
S.801-3521	1 3/8"	21

**Shear Pin  
With 1/4" Pin Hole**

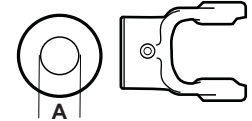

Stock Number	A Bore
S.802-3520	1 1/4"
S.802-3522*	1 3/8" (*1/4" & 1/2" Pin Hole)
S.802-3524	1 1/2"

**Torque Limiter Flange**

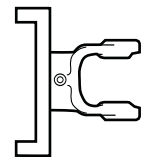

Stock Number
S.803-3500

35 Series

Square Bore With Set Screw

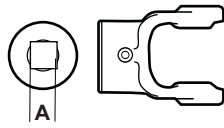

Stock Number	A Bore
S.804-3516	1"
S.804-3518	1 1/8"
S.804-3519	1 3/16"
S.804-3520	1 1/4"
S.804-3524	1 1/2"
S.804-3526	1 5/8"

Guard - Plastic Use Bearing Kit (S.22567)

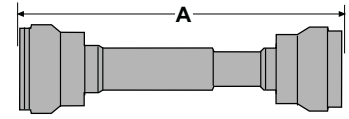

Stock Number	A Length
S.59605	29 1/2"
S.59606	39 1/2"
S.59607	51 1/2"

Round Bore Double Keyway & Set Screw

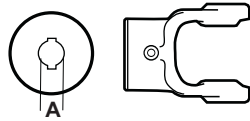

Stock Number	A Bore	Double Keyway
S.806-3520	1 1/4"	1/4" & 5/16"
S.806-3522	1 3/8"	5/16" & 3/8"

Bearing Kit - 250

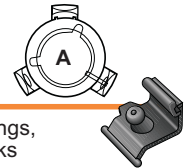

Stock Number	Kit Contains
S.22567	2 x A=52.8mm ID Bearings, 2 x S.56509 Nipple Locks

Yoke & Shaft Assembly 1 3/16" Square Shaft

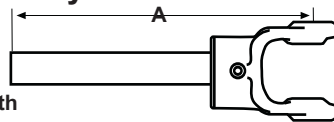

Stock Number	A Length
S.10003542	28 1/2"
S.10003548	33 1/4"
S.10003560	45"

Universal Joint - Quick Disconnect to Shaft Weld Yoke

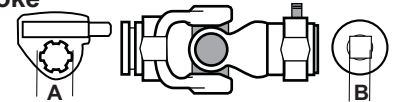

Stock Number	A Bore	B Bore
S.15063500	1 3/8" x 6	1 3/16" Square

Yoke, Tube & Sleeve Assembly 1 3/16" Square

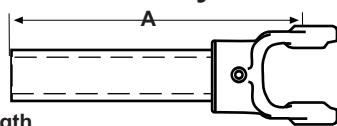

Stock Number	A Length
S.11003535	21 5/8"
S.11003548	33 1/4"
S.11003560	45"

Universal Joint - Torque Tube Weld to Implement Yoke - Round Yoke Furnished with Keyway & Set Screw

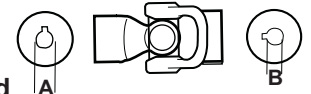

Stock Number	A Bore	B Bore
S.15003520	2 1/8" (.120 Wall)	1 1/4"
S.15003522	2 1/8" (.120 Wall)	1 3/8"
S.15003524	2 1/8" (.120 Wall)	1 1/2"



44 Series

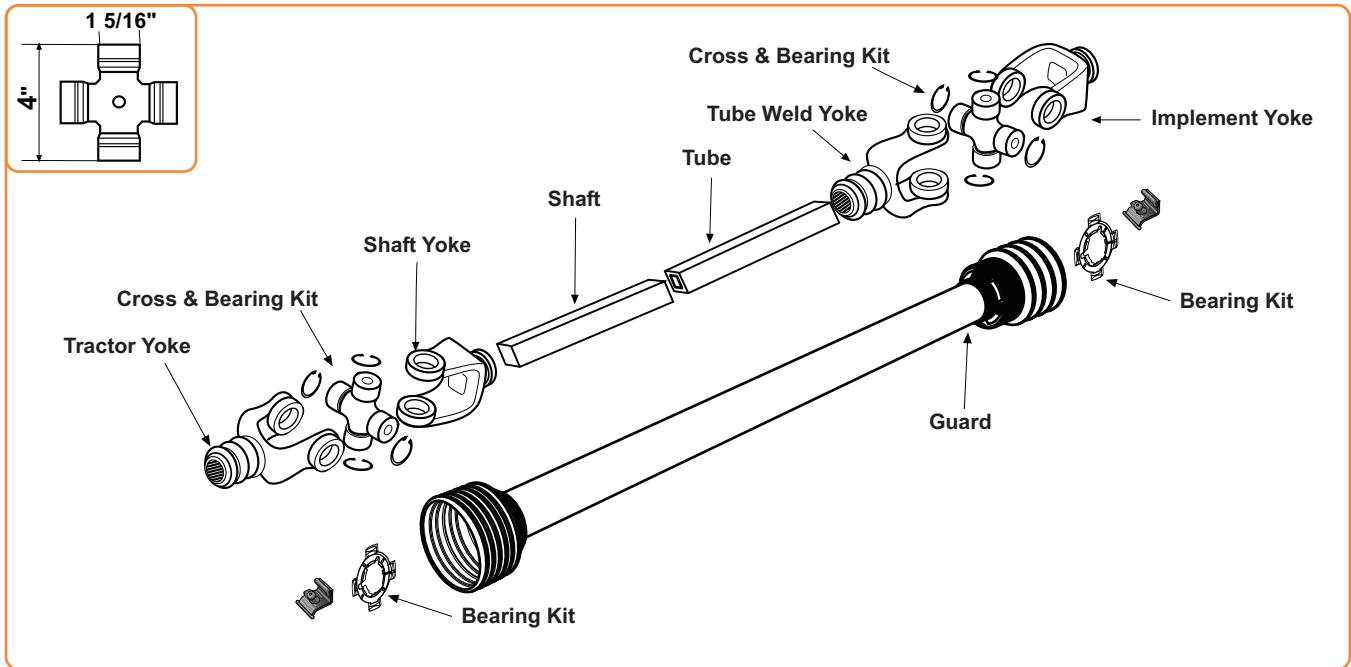

**Tractor Yoke Safety Slide Lock**

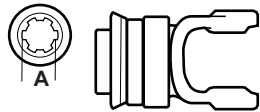

Stock Number	A Bore	Spline
S.100-4406	1 3/8"	6
S.100-4421	1 3/8"	21

**Cross & Bearing Kit - Internal Lock**

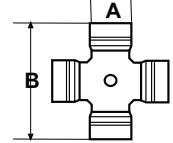

Stock Number	A	B
S.200-4400	1 5/16"	4"

**Tractor Yoke Quick Disconnect**

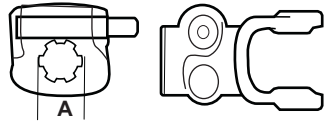

Stock Number	A Bore	Spline
S.102-4406	1 3/8"	6
S.102-4420	1 3/4"	20
S.102-4421	1 3/8"	21

**Shaft Weld Yoke With Bearing Groove**

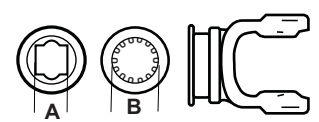

Stock Number	A Bore	B Bore	Spline
S.300-4400	1 5/16" Square	-	-
S.302-4400	-	1 11/16"	20

**Tractor Yoke Ball Shear Device with Spring-Lok**

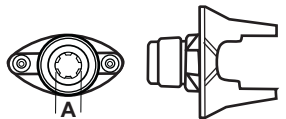

Stock Number	A Bore	Spline	Shear Bolt
S.104-4406	1 3/8"	6	3/8" x 16 Gr. 5

**Shaft 1 5/16" Square**

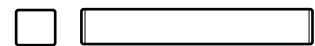

Stock Number	Length
S.400-0021	6'

**44 Series**

**Spline Shaft**  
1 11/16" x 20 Spline

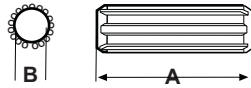

Stock Number	A Length	B Bore
S.404-2120	3'	1 5/16" x 20
S.404-2720* (*Induction Hardened)	3'	1 11/16" x 20

**Slip Sleeve -**  
1 5/16" Square  
with Grease Groove

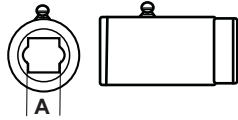

Stock Number	Length	Fits Tube Size B
S.500-4400	5"	2 1/2" (.134 Wall)

**Slip Sleeve -**  
With Grease Reservoir

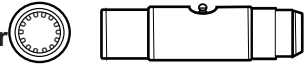

Stock Number	Length	Bore	Fits Tube Size
S.502-3500	6"	1 5/16" x 20	2 1/2" (.134 Wall)
S.503-3500	8"	1 11/16" x 20	2 1/2" (.134 Wall)

**Tube**

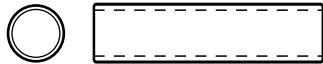

Stock Number	Length	Fits Tube Size
S.602-4400	6'	2 1/2" (.134 Wall)

**Tube Weld Yoke -**  
with Bearing Groove



Stock Number	A Bore
S.701-4400	2 1/2" (.120 Wall)

**Implement Yoke -**  
Round Bore  
With Keyway &  
Set Screw

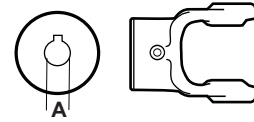

Stock Number	A Bore	Standard Keyway
S.800-4420	1 1/4"	1/4"
S.800-4422	1 3/8"	5/16"
S.800-4423	1 7/16"	3/8"
S.800-4424	1 1/2"	3/8"
S.800-4426	1 5/8"	3/8"
S.800-4428	1 3/4"	3/8"
S.800-4432	2"	1/2"

**Spline Bore -**  
With 21/64" Pin Hole

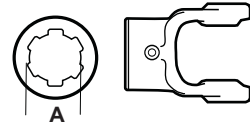

Stock Number	A Bore	Spline
S.801-4406	1 3/8"	6
S.801-4421	1 3/8"	21

**Square Bore**  
With Set Screw

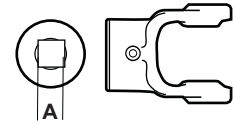

Stock Number	A Bore
S.804-4418	1 1/8"

**Round Bore**  
Double Keyway &  
Set Screw

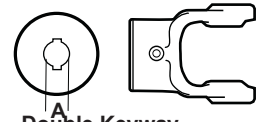

Stock Number	A Bore	Double Keyway
S.806-4420	1 1/4"	5/16" & 1/4"
S.806-4422	1 3/8"	5/16" & 1/4"
S.806-4424	1 1/2"	5/16" & 3/8"

44 Series

**Guard - 350  
Plastic  
(Use Bearing Kit  
S.22569)**

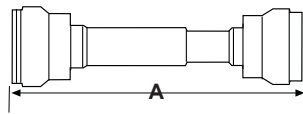

Stock Number    A Length

S.59613	29 1/2"
S.59614	39 1/2"
S.59615	51 1/2"

**Yoke, Tube & Sleeve Assembly  
1 5/16" Square**

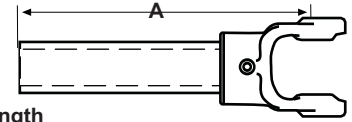

Stock Number    A Length

S.11004448	33 5/8"
S.11004460	45 5/8"

**Yoke & Shaft Assembly  
1 5/16" Square**

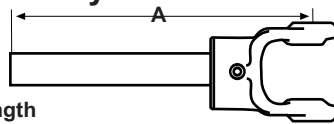

Stock Number    A Length

S.10004448	33 1/8"
S.10004460	45 1/8"

**Universal Joint - Quick Disconnect  
to Shaft Weld Yoke**

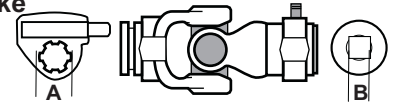

Stock Number    A Length    B Bore

S.15064400	1 3/8" x 6	1 5/16" Square
------------	------------	----------------

**Driveline**

Driveline is furnished without Cross & Bearing Kit and Implement Yoke. Select kit and Implement Yoke as required. When Cross & Bearing Kit and Implement Yoke are assembled, the overall compressed length of the driveline will be 48".

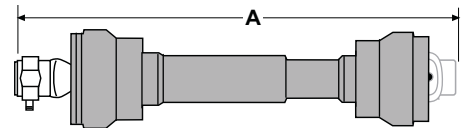

Stock Number    Tractor Yoke    A Length

S.14004448	1 3/8" x 6 Quick Disconnect	48"
------------	-----------------------------	-----

**Bearing Kit - 250**

Stock Number    Kit Contains

S.22567	2 x A=52.8mm ID Bearings, 2 x S.56509 Nipple Locks
---------	---

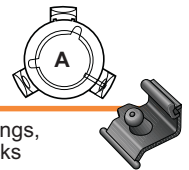

**55 Series**

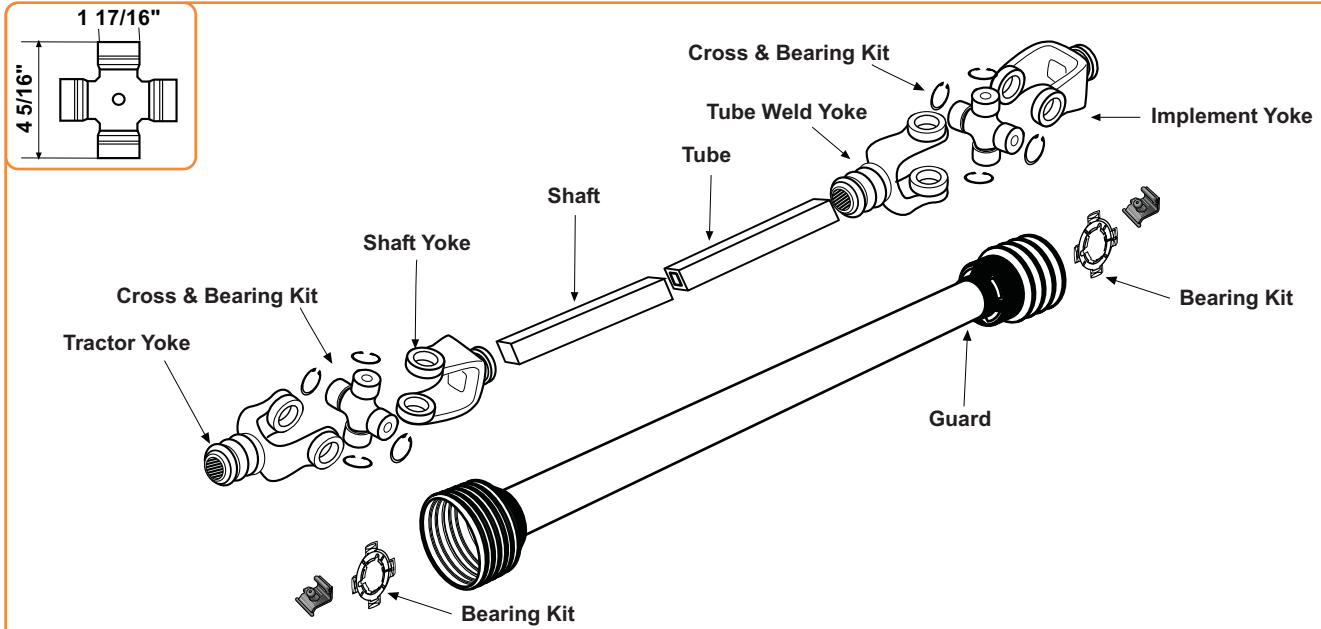

**Tractor Yoke Safety Slide Lock**

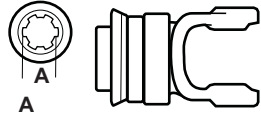

Stock Number	A Bore	Spline
S.101-5506	1 3/8"	6
S.101-5520	1 3/4"	20
S.101-5521	1 3/8"	21

**Cross & Bearing Kit - External Lock**

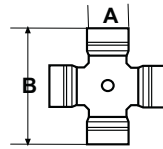

Stock Number	A	B
S.200-5500	1 17/16"	4 5/16"

**Tractor Yoke Quick Disconnect**

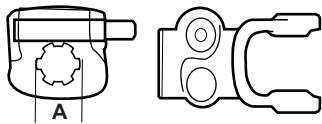

Stock Number	A Bore	Spline
S.102-5506	1 3/8"	6
S.102-5520	1 3/4"	20
S.102-5521	1 3/8"	21

**Shaft Weld Yoke With Bearing Groove**

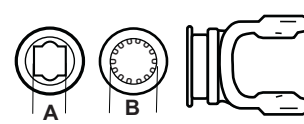

Stock Number	A Bore	B Bore
S.300-5500	1 5/16" Square	
S.302-5500		1 11/16" x 20 Spline

**Tractor Yoke Ball Shear Device with Spring-Lok**

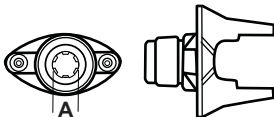

Stock Number	A Bore	Spline	Shear Bolt
S.104-5506	1 3/8"	6	3/8" x 16 Gr. 5

**Shaft 1 5/16" Square**

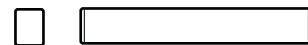

Stock Number	Length
S.400-0021	6'

55 Series

**Shaft -  
1 11/16" x 20 Spline**

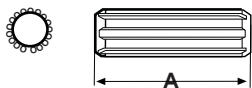

Stock Number	Length	A Bore
S.404-2120	3'	1 5/16" x 20
S.404-2720* (*Induction Hardened)	3'	1 11/16" x 20

**Slip Sleeve  
1 5/16" Square  
with Grease Groove**

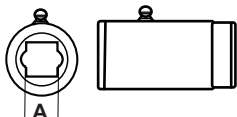

Stock Number	Length	Fits Tube Size
S.500-4400	5"	2 1/2" (.134 Wall)

**Slip Sleeve  
With Grease Reservoir**



Stock Number	Length	Fits Tube Size
S.502-3500	8"	1 5/16" - 20 Spline 2 1/8" (.120 Wall)
S.503-3500	8"	1 11/16" - 20 Spline 2 1/2" (.120 Wall)

**Tube**

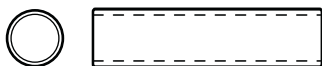

Stock Number	Length	Fits Tube Size
S.602-4400	6'	2 1/2" (.120 Wall)

**Tube Weld Yoke  
with Bearing Groove**



Stock Number	A Bore
S.701-5500	2 1/2" (.120 Wall)

**Implement Yoke  
Round Bore  
With Keyway &  
Set Screw**

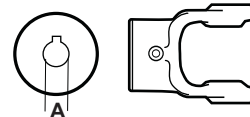

Stock Number	A Bore	Standard Keyway
S.800-5522	1 3/8"	5/16"
S.800-5524	1 1/2"	3/8"
S.800-5526	1 5/8"	3/8"
S.800-5528	1 3/4"	3/8"
S.800-5532	2"	1/2"

**Spline Bore  
With 21/64" Pin Hole**

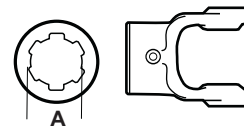

Stock Number	A Bore	Spline
S.801-5506	1 3/8"	6
S.801-5521	1 3/8"	21

**Clamp Yoke**

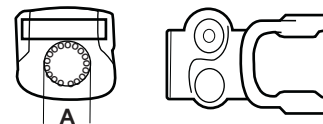

Stock Number	A Bore	Spline
S.807-5520	1 3/4"	20
S.807-5527	1 3/4"	27

**55 Series**

**Guard - 350 Plastic (Use Bearing Kit S.22569)**

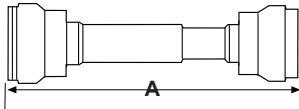

Stock Number	A Length
S.59613	29 1/2"
S.59614	39 1/2"
S.59615	51 1/2"

**Yoke, Tube & Sleeve Assembly 1 5/16" Square**

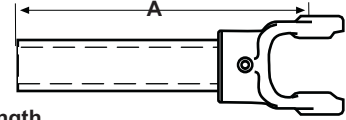

Stock Number	A Length
S.11005548	33 3/8"
S.11005560	45 3/8"

**Yoke & Shaft Assembly 1 5/16" Square**

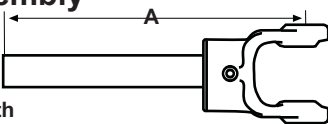

Stock Number	A Length
S.10005548	32 3/4"
S.10005560	44 3/4"

**Universal Joint - Quick Disconnect to Shaft Weld Yoke - Repair Kit**

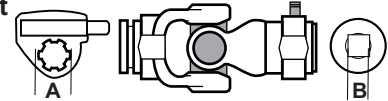

Stock Number	A Bore	B Bore
S.15065500	1 3/8" x 6	1 5/16" Square

**Driveline**

Drivelines are furnished without Cross & Bearing Kit and Implement Yoke. Select kit and Implement Yoke as required. When Cross & Bearing Kit and Implement Yoke are assembled, the overall compressed length of the driveline will be 48" or 60".

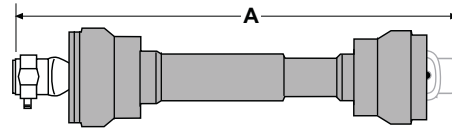

Stock Number	Tractor Yoke	A Length
S.14005548	1 3/8" x 6 Quick Disconnect	48"
S.14005560	1 3/8" x 6 Quick Disconnect	60"

**Special Shaft Record**

**Bearing Kit - 350**

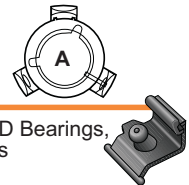

Stock Number	Kit Contains
S.22569	2 x A=67.2mm/83.6mm ID Bearings, 2 x S.56509 Nipple Locks

W Series

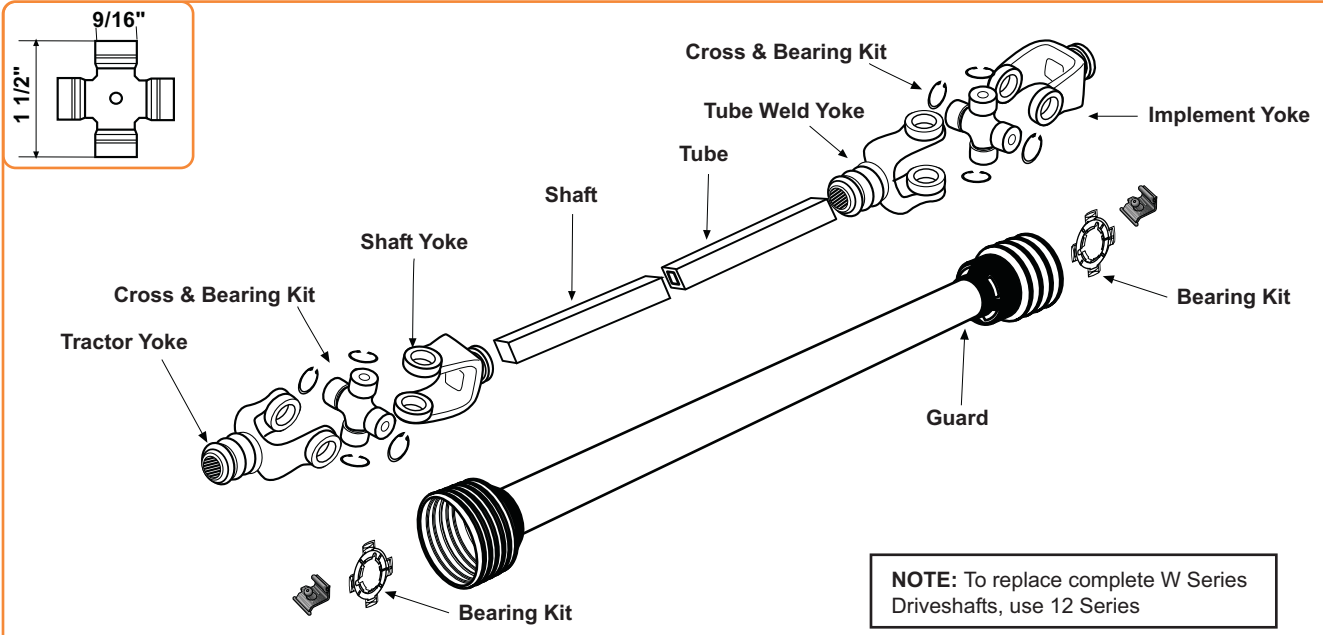

**NOTE:** To replace complete W Series Driveshafts, use 12 Series

**Tractor Yoke Quick Disconnect**

Stock Number	A Bore	Spline
S.102-0706	1 3/8"	6

**Shaft 15/16" Square**

Stock Number	Length	Fits Tube
S.400-0015	6'	1 1/4" Square

**Cross & Bearing Kit - Internal Lock**

Stock Number	A	B
S.200-0700	9/16"	1 1/2"

**Tube 1 1/4" Square**

Stock Number	Length	Fits Shaft
S.600-0015	6'	15/16" Square

**Shaft Weld Yoke With Bearing Groove**

Stock Number	A Bore
S.300-0700	1 5/16" Square

**Tube Weld Yoke With Bearing Groove**  
(Use shaft to align and butt weld to shaft)

Stock Number	A Bore	Fits Tube
S.700-0700	15/16" Square	1 1/4"

**W Series**

**Implement Yoke  
Round Bore  
With Keyway &  
Set Screw**

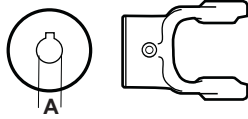

Stock Number	A Bore	Standard Keyway
S.800-0716	1"	1/4"
S.800-0718	1 1/8"	1/4"
S.800-0720	1 1/4"	1/4"

**Guard - 250  
Plastic  
(Use Bearing Kit  
S.22568)**

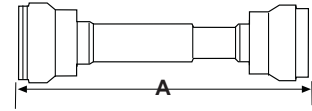

Stock Number	A Length
S.59605	29 1/2"
S.59606	39 1/2"
S.59607	51 1/2"

**Driveline**

Driveline is furnished without Cross & Bearing Kit and Implement Yoke. Select kit and Implement Yoke as required. When Cross & Bearing Kit and Implement Yoke are assembled, the overall compressed length of the driveline will be 48".

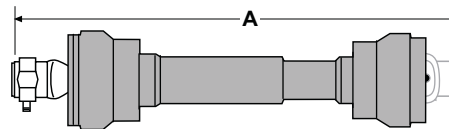

Stock Number	Tractor Yoke	Implement Yoke	A Length
S.14000700	1 3/8" x 6 Quick Disconnect	1 1/4" Round 1/4" Keyway	48"

Complete 12 Series Drivelines can replace W Series

**Special Shaft Record**

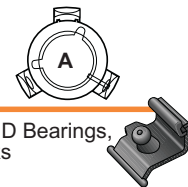

**Bearing Kit - 350**



Stock Number	Kit Contains
S.22568	2 x A=41.8mm/71.4mm ID Bearings, 2 x S.56509 Nipple Locks

0675 Series

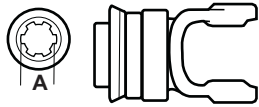
**Tractor Yoke Spring-Lok**



Stock Number	A Bore	Spline
S.100-0506	1 3/8"	6

**Tractor Yoke Quick Disconnect**

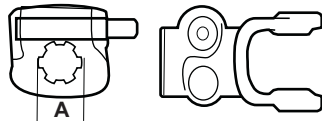

Stock Number	A Bore	Spline
S.102-0506	1 3/8"	6

**Cross & Bearing Kit - Internal Lock**

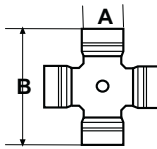

Stock Number	A	B
S.200-0675	15/16"	2 5/16"

**Shaft Weld Yoke With Bearing Groove**



Stock Number	A Bore
S.300-0500	3/4" X 7/8"

**Tube Weld Yoke With Bearing Groove**



Stock Number	A Bore
S.700-0500	1" X 1 1/8"

**Implement Yoke Round Bore With Keyway & Set Screw**

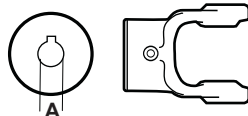

Stock Number	A Bore	Standard Keyway
S.800-0510	5/8"	3/16"
S.800-0512	3/4"	3/16"

**Implement Yoke Spline Bore With 5/8" Pin Hole**

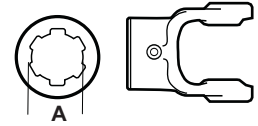

Stock Number	A Bore	Spline
S.801-0506	1 3/8"	6
S.801-0518	1 1/8"	6

**Implement Yoke Square Bore With Set Screw**

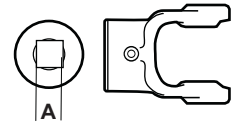

Stock Number	A Bore
S.804-0512	3/4"
S.804-0514	7/8"
S.804-0516	1"

**Implement Yoke Round Bore With Double Keyway & Set Screw**

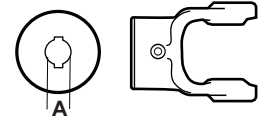

Stock Number	A Bore	Double Keyway
S.806-0514	7/8"	3/16" & 1/4"
S.806-0516	1"	3/16" & 1/4"
S.806-0518	1 1/8"	1/4" & 5/16"
S.806-0520	1 1/4"	1/4" & 5/16"

**Guard - 250 Plastic (Use Bearing Kit S.22566)**

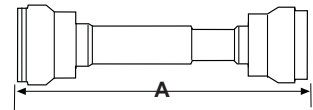

Stock Number	A Length
S.59605	29 1/2"
S.59606	39 1/2"
S.59607	51 1/2"

**1000 Series**

**Tractor Yoke Quick Disconnect**

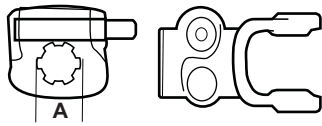

Stock Number	A Bore	Spline
S.102-1006	1 3/8"	6

**Implement Yoke Spline Bore**

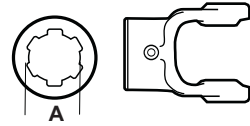

Stock Number	A Bore	Spline
S.10-4481	7/8"	13

**Cross & Bearing Kit - Internal Lock**

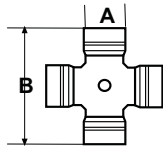

Stock Number	A	B
S.200-1000	15/16"	2 19/64"

**Implement Yoke Hexagon**

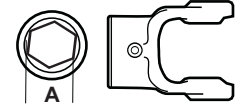

Stock Number	A Bore
S.10-3162	7/8"

**Implement Yoke Round Bore With Keyway & Set Screw**

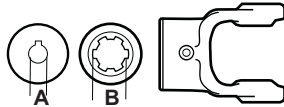

Stock Number	A Bore	Keyway	B Spline
S.810-1016	1"	1/4"	10 Spline
S.812-1018	1 1/8"		

**Implement Yoke Hexagon**

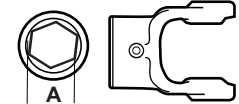

Stock Number	A Bore
S.10-4282	7/8"
S.10-0432	1 1/8"

**Bearing Kit - 250**

Stock Number	Kit Contains
S.22566	2 x A=46.4mm/71.4mm ID Bearings, 2 x S.56509 Nipple Locks

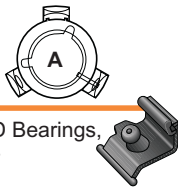

**Guard - 250 Plastic (Use Bearing Kit S.22566)**

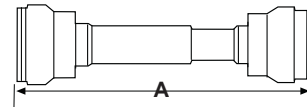

Stock Number	A Length
S.59605	29 1/2"
S.59606	39 1/2"
S.59607	51 1/2"

1800 Series

**Tractor Yokes  
Quick Disconnect  
Pin Type**  
(Tractor end use only)

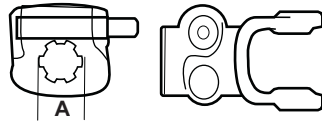

Stock Number	A Bore	Spline
S.18-7403	1 3/8"	6
S.18-7406	1 3/8"	21

**Hexagon Bore**

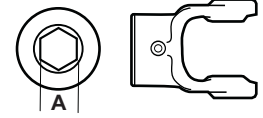

Stock Number	A Bore	Hole
S.18-7128	1 1/8"	3/8"-16

**Tractor Yokes  
Quick Disconnect  
Collar Type**

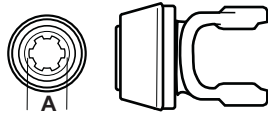

Stock Number	Collar Repair Kit	A Bore	Spline
S.18-7330	S.56-3001	1 3/8"	6

**Spline Bore**

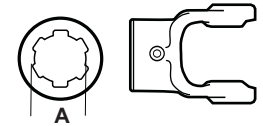

Stock Number	A Bore	Spline	Hole
S.18-7132	1 3/8"	6	21/64"

**Cross & Bearing Kit  
Inside Lock-up**

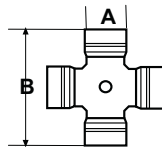

Stock Number	Bearing	Length	Shear Bolt
S.200-1875	1"	3 1/8"	3/8" x 16 Gr. 5

**Square Bore**

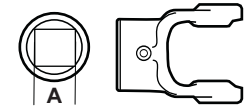

Stock Number	A Bore
S.18-7125	1"
S.18-7127	1 1/4"

**Implement Yokes  
Round**

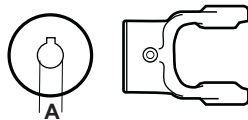

Stock Number	A Bore	Keyway	Hole Size
S.18-7115	1"	1/4"	3/8"-16
S.18-7117	1 1/8"	5/16"	3/8"-16
S.18-7119	1 1/4"	5/16"	3/8"-16
S.18-7315	1 3/8"	-	17/32 Hole
S.18-7120	1 3/8"	5/16"	3/8"-16
S.18-7313	1 1/2"	3/8"	3/8"-16

**Torque Limiter**

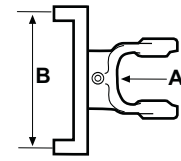

Stock Number	A Bore	Flange	B Bolt	Holes
S.48-7202	1 1/16"	8" Rect	7 1/4"	11/32" x 4

**Shaft Weld Yoke  
With Bearing Groove**

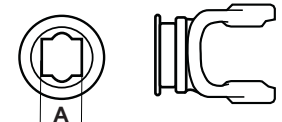

Stock Number	Bore	Bearing Groove
S.18-7327	1" x 1 1/8"	2 1/16"
S.18-7149	1" x 1 1/8"	1 3/4"

**1800 Series**

**Shaft -  
1" x 1 1/8" Rectangular**

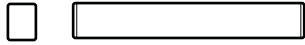

Stock Number	Length
S.400-1618	6'

**Slip Sleeve -  
1" x 1 1/8" Rectangular**

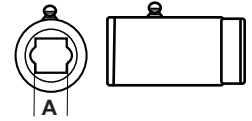

Stock Number	Length	Fits Tube Size
S.53-2034	5"	2" (.083 Wall)

**Tube Weld Yoke -  
with Bearing Groove**

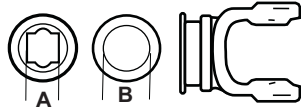

Stock Number	A Bore	Fits Tube B
S.18-7328	1 9/32" X 1 13/32"	1 1/4" x 1 3/8"
S.18-7305	1 1/2" Rd	2" (.083 Wall)

**Yoke & Shaft Assembly  
1" x 1 1/8" Shaft**

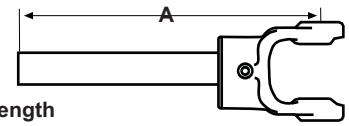

Stock Number	A Length
S.64-1828	24"
S.64-1840	36"
S.64-1852	48"

**Tube -  
2" Round**

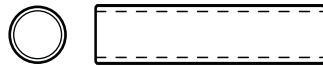

Stock Number	Length	Tube
S.602-1400	6'	2" (.083 Wall)

**Yoke & Tube Assembly  
1" x 1 1/8" Rectangular**

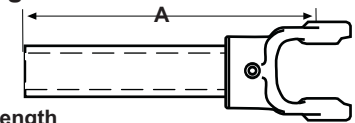

Stock Number	A Length
S.65-1828	24"
S.65-1840	36"
S.65-1852	48"

**Tube -  
1 1/4" x 1 3/8"  
Rectangular OD**



Stock Number	Length	Fits Shaft
S.600-2022	6'	1" x 1 1/8"

**Driveline with World Shield™**

Driveline is furnished with Cross & Bearing Kit and Shield. Tractor and Implement Yoke required.

Stock Number	A Min-Max
S.58-1828	28" - 38"

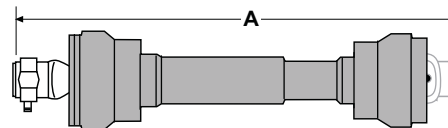

2600 Series

**Tractor Yokes  
Quick Disconnect  
Pin Type**  
(Tractor end use only)

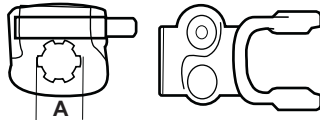

Stock Number	A Bore	Spline	Pin Repair Kit
S.26-5321	1 3/8"	6	S.56-1857
S.26-5319	1 3/8"	21	S.56-1857

**Tractor Yokes  
Quick Disconnect  
Collar Type**

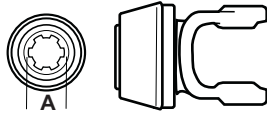

Stock Number	A Bore	Spline	Collar Repair Kit
S.126-5306	1 3/8"	6	S.56-3001
S.126-5325	1 3/8"	21	S.56-3001

**Cross & Bearing Kit  
External Lock**

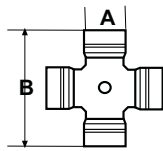

Stock Number	Bearing	Length
S.200-2600	1 3/8"	4 3/16"

**Tube  
2 3/4" Round**

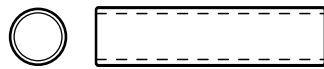

Stock Number	Length	Fits Tube
S.70-2750	6'	2 3/4" (.109 Wall)

**Tube Weld Yoke -  
with Bearing Groove  
2" Round**



Stock Number	A Bore	Fits Tube
S.26-5155	2" (.109 Wall)	2 3/4" (.109 Wall)

**Implement Yoke -  
Round Bore  
With Keyway &  
Set Screw**

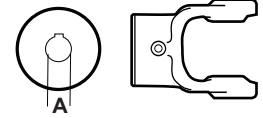

Stock Number	A Bore	Standard Keyway
S.26-5118	1 3/84"	5/16"
S.26-5119	1 1/2"	3/8"
S.26-5131	1 3/4"	3/8"

**Spline Bore -  
With 21/64" Pin Hole**

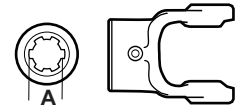

Stock Number	A Bore	Spline
S.26-5138	1 3/8"	6

**Shaft Weld Yoke  
Square Bore**

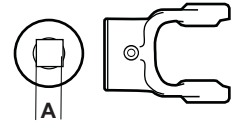

Stock Number	A Bore
S.26-5148	1 15/16"

**Shaft -  
1 5/16" Square**

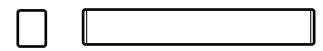

Stock Number	Length
S.400-0021	6'

**Slip Sleeve -  
1" x 1 1/8" Rectangular**

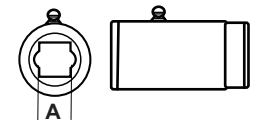

Stock Number	A Bore	Length	Fits Tube Size
S.500-2600	1 5/16"	5'	2 3/4" (.109 Wall)



Miscellaneous

**Cross & Bearing Kit  
Inside Lock-up**

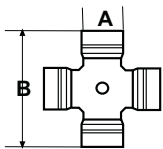

Stock Number	Bearing	Length
S.2-3011	1 1/8"	3 11/16"

**Tractor Yoke Locking  
Device Repair Kit  
Spring-Lok**

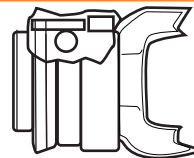

Stock Number	Spline
S.13003100	6 & 21
S.13003115	15

**Cross & Bearing Kit  
1 FR Series  
Inside Lock-up**

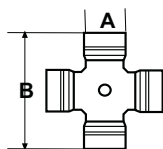

Stock Number	Bearing	Length
S.200-0100	7/8"	2 5/16"

**Tractor Yoke Locking  
Device Repair Kit  
Safety Slide Lock**

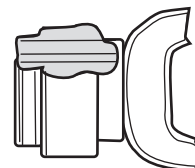

Stock Number	Spline
S.13003000	6 & 21
S.13003020	20

**Cross & Bearing Kit  
3 DR Series  
Inside Lock-up**

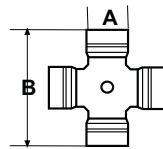

Stock Number	Bearing	Length
S.200-0300	1"	3 15/16"

**Tractor Yoke Locking  
Device Repair Kit  
Quick Disconnect**

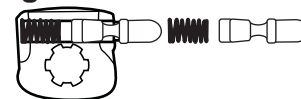

Stock Number	Spline	Series
S.13002006	6	Weasler
S.13002020	20	Weasler
S.13002021	21	Weasler
S.56-1857	-	Neapco 1800
S.56-3001	-	Neapco 2600

**Shaft  
6' Length -  
Square**



Stock Number	OD
S.400-0012	3/4"
S.72-0875	7/8"
S.400-0016	1"
S.400-0020	1 1/4"

**Tractor Yoke Locking  
Device Repair Kit  
Quick Disconnect**



Stock Number	Fits
S.01090	Most North American Yokes

**Tube -  
6' Length -  
Square**



Stock Number	OD	Fits Shaft
S.600-0012	1"	3/4"
S.600-0016	1 1/4"	1"
S.600-0020	1 5/8"	1 1/4"

**TORQMASTER Modular Clutch**

**METRIC**  
Interchanges with:  
Bondioli and Pavesi, 4, 5, 6, 8 Series and  
Walterscheid 2300, 2400, 2500 Series

**NORTH AMERICAN**  
Weasler 14, 35, 44, 55  
Interchanges with:  
Neapco 2600 Series and  
Walterscheid 1480 Series

**Features and Benefits**

- Superior Performance
- Long Life
- Isolates and Dissipates Heat
- 'User Friendly', Easy to Service
- Easy Assembly with 1/2" Wrench
- Free Motion - Ease of Hookup
- Minimum Adjustment Required
- Auto-Lok Available
- Replacement Clutch for most Farm Implements (for use on implement end of driveline only)
- Torque Setting from 6000 in/lbs to 18,000 in/lbs
- Overrunning Feature also Available
- Modular Construction Covers a Wide Variety of Applications
- Applications for the Torquemaster Modular Clutch:
  - Spreaders
  - Mixers
  - Mower Conditioners
  - Rotary Cutters
  - Flail Shredders
  - Grain Carts
  - Balers

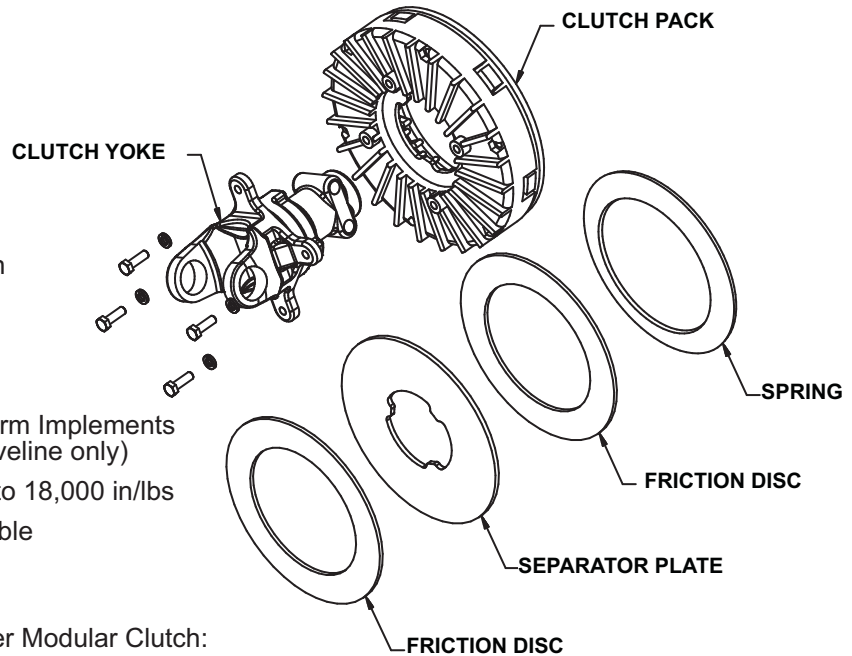

**Instructions for Ordering**

- Determine Driveline Series for either North American or Metric applications
- Identify the Connecting Shaft Size and Method of Attachment (i.e.: clamp, bolt, keyway)
- Obtain Torque Setting from Owner/Operator Manual
- If Torque Setting is Not Available, Use the Following Clutch Pak Selection Guide:
  - Order Clutch Yoke and Clutch Pak Separately by Stock Number
  - For Installation, Attach Clutch Yoke to the Driveline first, Then Mount the Clutch Pak to the Clutch Yoke
  - Use the Modular Clutch on the Implement End of the Driveline Only
  - If the Implement Input Connection Guard is Removed for Service, Reinstall the Guard Before Using the Machine
  - Some Implements (i.e.: mower conditioner, flail shredder) Require an Overrunning Feature Incorporated into the Clutch. If the Replacement Clutch Requires this Feature, Order the Appropriate Modular Clutch and Clutch Yoke

**If you have an implement that does NOT appear in the Clutch Pak Selection Guide, use this chart as a general guideline for selecting the proper Clutch Pak.**

North American	Metric	Stock Number
14 Series	Bondioli & Pavesi 4 Series Walterscheid 2300 Series	<b>S.57012000</b>
35 Series	Bondioli & Pavesi 5 Series Walterscheid 2400 Series	<b>S.57015000</b>
44 Series	Bondioli & Pavesi 6 & 7 Series Walterscheid II Series	<b>S.57018000</b>
55 Series	Bondioli & Pavesi 8 Series Walterscheid 2500 Series	<b>S.57018000</b>

**TORQMASTER Clutch Pak Selection Guide**

**Spreader**

Friction Clutch Stock Number	Overrunning Clutch Stock Number	540 RPM in•lb•torque	1000 RPM in•lb•torque
Capacity: Less than 240 Bushels or 150 cu.ft.			
S.57012000	S.57112000	12000	
Capacity: Between 241-400 Bushels or 151 - 250 cu.ft.			
S.57012000	S.57112000		12000
S.57015000	S.57115000	15000	
Capacity: Between 401-560 Bushels or 251 - 350 cu.ft.			
S.57015000	S.57115000		15000
S.57018000	S.57118000	18000	
Capacity: Greater than 560 Bushels or 350 cu.ft.			
S.57018000	S.57118000		18000
S.57018000	S.57118000	18000	

**Mixer**

Friction Clutch Stock Number	Overrunning Clutch Stock Number	540 RPM in•lb•torque	1000 RPM in•lb•torque
Capacity: Less than 240 Bushels or 150 cu.ft.			
S.57012000	S.57112000	12000	
Capacity: Between 241-400 Bushels or 151 - 250 cu.ft.			
S.57012000	S.57112000		12000
S.57015000	S.57115000	15000	
Capacity: Between 401-560 Bushels or 251 - 350 cu.ft.			
S.57015000	S.57115000		15000
S.57018000	S.57118000	18000	
Capacity: Greater than 560 Bushels or 350 cu.ft.			
S.57018000	S.57118000		18000
S.57018000	S.57118000	18000	

**Snowblowers**

Friction Clutch Stock Number	540 RPM in•lb•torque	1000 RPM in•lb•torque
Width of Cut: Less than 60"		
S.57012000		12000
S.57015000	15000	
Width of Cut: 61" - 70"		
S.57015000		15000
S.57018000	18000	
Width of Cut: 71" - 80"		
S.57018000		18000
S.57018000	18000	
Width of Cut: 81" - 90"		
S.57018000	N/A	18000
Width of Cut: Greater than 90"		
S.57018000	N/A	18000

**Grain Cart**

Friction Clutch Stock Number	Overrunning Clutch Stock Number	540 RPM in•lb•torque	1000 RPM in•lb•torque
S.57012000	S.57112000	12000	

**Mower Conditioner**

Friction Clutch Stock Number	Overrunning Clutch Stock Number	540 RPM in•lb•torque	1000 RPM in•lb•torque
Sickle Bar - less than 10 feet			
S.57012000	S.57112000	12000	
Sickle Bar - 10 - 13 feet			
S.57012000	S.57112000		12000
S.57015000	S.57115000	15000	
Sickle Bar - 14 - 17 feet			
S.57015000	S.57115000		15000
S.57018000	S.57118000	18000	
Rotary Disk - less than 10 feet			
S.57012000	S.57112000		12000
Rotary Disk - 11 - 13 feet			
S.57015000	S.57115000		15000
Rotary Disk - 14 - 17 feet			
S.57018000	S.57118000		18000

**Rotary Cutter - 1 Clutch/Machine**

Friction Clutch Stock Number	Overrunning Clutch Stock Number	540 RPM in•lb•torque	1000 RPM in•lb•torque
Deck Width - 4 - 7 feet			
S.570-9000	S.571-9000		9000 / 12000
S.57012000	S.57112000	12000	
Deck Width - 8 - 13 feet			
S.57012000	S.57112000		12000
S.57015000	S.57115000	15000	
Deck Width - 14 - 16 feet			
S.57015000	S.57115000		15000
S.57018000	S.57118000	18000	
Deck Width - 17 - 20 feet			
S.57018000	S.57118000		18000
S.57018000	S.57118000	18000	
Deck Width - larger than 20 feet			
S.57018000	S.57118000		18000
Section Width - less than 4 feet			
S.550-6000	S.551-6000	6000	6000
Section Width - 4 - 6 feet			
S.570-9000	S.570-9000		9000 / 12000
S.57012000	S.57112000	12000	
Section Width - greater than 6 feet			
S.57012000	S.57112000		12000
S.57015000	S.57115000	15000	

**Round Baler**

Friction Clutch Stock Number	Overrunning Clutch Stock Number	540 RPM in•lb•torque	1000 RPM in•lb•torque
Bale Weight - less than 600 lbs.			
S.57012000	S.57112000	12000	
Bale Weight - 600 - 1500 lbs.			
S.57012000	S.57112000		12000
S.57015000	S.57115000	15000	
Bale Weight - 1501 - 2500 lbs.			
S.57015000	S.57115000		15000
S.57018000	S.57118000	18000	

**TORQMASTER Modular Clutch Components**

\* SPECIAL ORDER

**Clutch Paks  
5", 7"**

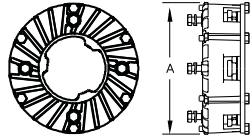

Clutch Stock Number	Overrunning Clutch Stock Number	in·lbs	Dim. "A"
S.550-6000	S.551-6000*	6000	6 1/4"
S.570-9000	S.571-9000*	9000	7"
S.57012000	S.57112000*	12000	7"
S.57015000	S.57115000*	15000	7"
S.57018000	S.57118000*	18000	7"

**35 Series**

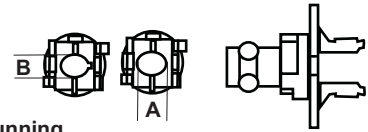

Clamp Yoke Stock Number	Overrunning Clamp Yoke Stock Number	A Bore	Spline	B Bore
S.817-3506	S.818-3506*	1 3/8"	6	
S.817-3521*	S.818-3521*	1 3/8"	21	
S.817-3524*	S.818-3524*			1 1/2" Rd

**14 Series**

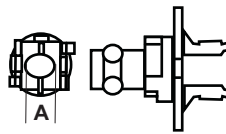

Clamp Yoke Stock Number	Overrunning Clamp Yoke Stock Number	A Bore	Spline
S.817-1406*	S.818-1406*	1 3/8"	6
S.817-1421*	S.818-1421*	1 3/8"	21

**35 Series**

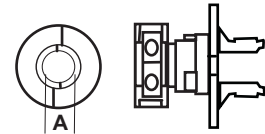

Clamp Yoke Stock Number	Overrunning Clamp Yoke Stock Number	A Bore	Spline
S.817-3520*	S.818-3520*	1 3/4"	20

**14 Series**

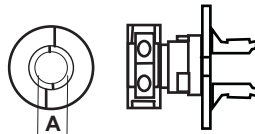

Clamp Yoke Stock Number	Overrunning Clamp Yoke Stock Number	A Bore	Spline
S.817-1420*	S.818-1420*	1 3/4"	20

**35 Series**

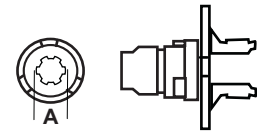

Auto-Lok Yoke Stock Number	Overrunning Auto-Lok Yoke Stock Number	A Bore	Spline
S.820-3506*	S.821-3506*	1 3/8"	6
S.820-3520*	S.821-3520*	1 3/4"	20
S.820-3521*	S.821-3521*	1 3/8"	21

**14 Series**

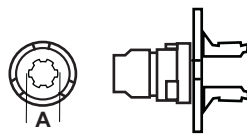

Auto-Lok Yoke Stock Number	Overrunning Auto-Lok Yoke Stock Number	A Bore	Spline
S.820-1406	S.821-1406*	1 3/8"	6
S.820-1421	S.821-1421*	1 3/8"	21

**35 Series  
w/ Keyway & Set Screw**

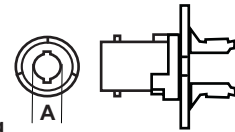

Round Bore Yoke Stock Number	Overrunning Round Bore Yoke Stock Number	A Bore
S.825-3522*	S.826-3522*	1 3/8" Rd

**14 Series  
w/ Keyway & Set Screw**

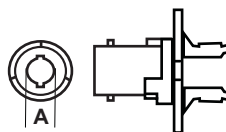

Round Bore Yoke Stock Number	Overrunning Round Bore Yoke Stock Number	A Bore
S.825-1420*	S.826-1420*	1 1/4" Rd
S.825-1422*	S.826-1422*	1 3/8" Rd

**44 Series**

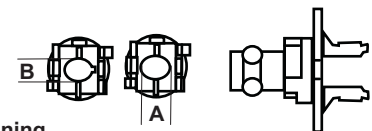

Clamp Yoke Stock Number	Overrunning Clamp Yoke Stock Number	A Bore	Spline	B Bore
S.817-4406	S.818-4406*	1 3/8"	6	
S.817-4421*	S.818-4421*	1 3/8"	21	
S.817-4424*	S.818-4424*			1 1/2" Rd

**TORQMASTER Modular Clutch Components**

\* SPECIAL ORDER

**44 Series**

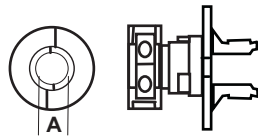

Clamp Yoke Stock Number	Overrunning Clamp Yoke Stock Number	A Bore	Spline
S.817-4420*	S.818-4420*	1 3/4"	20

**55 Series**

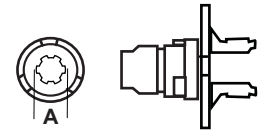

Auto-Lok Yoke Stock Number	Overrunning Auto-Lok Yoke Stock Number	A Bore	Spline
S.820-5506*	S.821-5506*	1 3/8"	6
S.820-5520*	S.821-5520*	1 3/4"	20
S.820-5521*	S.821-5521*	1 3/8"	21

**44 Series**

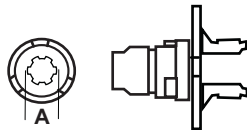

Auto-Lok Yoke Stock Number	Overrunning Auto-Lok Yoke Stock Number	A Bore	Spline
S.820-4406*	S.821-4406*	1 3/8"	6
S.820-4420*	S.821-4420*	1 3/4"	20
S.820-4421*	S.821-4421*	1 3/8"	21

**55 Series w/ Keyway & Set Screw**

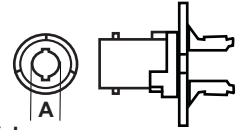

Round Bore Yoke Stock Number	Overrunning Round Bore Yoke Stock Number	A Bore
S.825-5522*	S.826-5522*	1 3/8" Rd

**44 Series w/ Keyway & Set Screw**

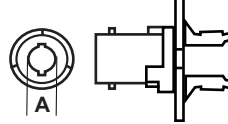

Round Bore Yoke Stock Number	Overrunning Round Bore Yoke Stock Number	A Bore
S.825-4422*	S.826-4422*	1 3/8" Rd

**Walterscheid 1480 Series Neapco 2600 Series**

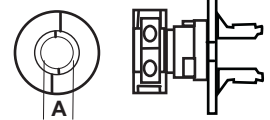

Clamp Yoke Stock Number	Overrunning Clamp Yoke Stock Number	A Bore	Spline
S.817-2606*	S.818-2606*	1 3/8"	6
S.817-2621*	S.818-2621*	1 3/8"	21

**55 Series**

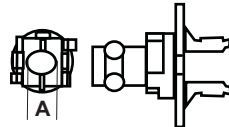

Clamp Yoke Stock Number	Overrunning Clamp Yoke Stock Number	A Bore	Spline
S.817-5506*	S.818-5506*	1 3/8"	6
S.817-5521*	S.818-5521*	1 3/8"	21

**Walterscheid 1480 Series Neapco 2600 Series**

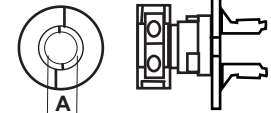

Clamp Yoke Stock Number	Overrunning Clamp Yoke Stock Number	A Bore	Spline
S.817-2620*	S.818-2620*	1 3/4"	20

**55 Series**

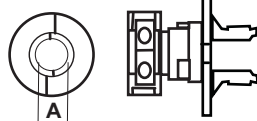

Clamp Yoke Stock Number	Overrunning Clamp Yoke Stock Number	A Bore	Spline
S.817-5520*	S.818-5520*	1 3/4"	20

**Walterscheid 1480 Series Neapco 2600 Series**

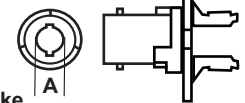

Round Bore Yoke Stock Number	Overrunning Round Bore Yoke Stock Number	A Bore
S.825-2622*	S.826-2622*	1 3/8" Rd

**TORQMASTER Modular Clutch Components**

\* SPECIAL ORDER

**Bondioli & Pavesi 4 Series  
Walterscheid 2300 Series**

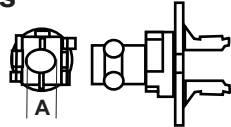

Clamp Yoke Stock Number	Overrunning Clamp Yoke Stock Number	A Bore	Spline
S.817-8406*	S.818-8406*	1 3/8"	6
S.817-8421*	S.818-8421*	1 3/8"	21

**Bondioli & Pavesi 6 Series  
Walterscheid 220 Series**

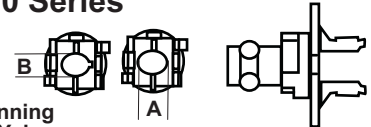

Clamp Yoke Stock Number	Overrunning Clamp Yoke Stock Number	A Bore	Spline	B Bore
S.817-8606*	S.818-8606*	1 3/8"	6	
S.817-8621*	S.818-8621*	1 3/8"	21	
S.817-8624*	S.818-8624*			1 1/2" Rd

**Bondioli & Pavesi 4 Series  
Walterscheid 2300 Series**



Round Bore Yoke Stock Number	Overrunning Round Bore Yoke Stock Number	A Bore
S.825-8422*	S.826-8422*	1 3/8" Rd

**Bondioli & Pavesi 6 Series  
Walterscheid 220 Series - 1 3/16"**

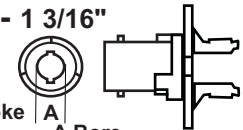

Round Bore Yoke Stock Number	Overrunning Round Bore Yoke Stock Number	A Bore
S.825-8622*	S.826-8622*	1 3/8" Rd

**Bondioli & Pavesi 5 Series - 1 3/16"**

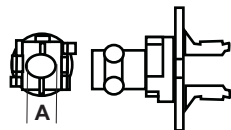

Clamp Yoke Stock Number	Overrunning Clamp Yoke Stock Number	A Bore	Spline
S.817-6506*	S.818-6506*	1 3/8"	6
S.817-6521*	S.818-6521*	1 3/8"	21

**Bondioli & Pavesi 8 Series**

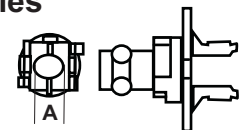

Clamp Yoke Stock Number	Overrunning Clamp Yoke Stock Number	A Bore	Spline	B Bore
S.817-6806*	S.818-6806*	1 3/8"	6	
S.817-6821*	S.818-6821*	1 3/8"	21	

**Bondioli & Pavesi 5 Series**

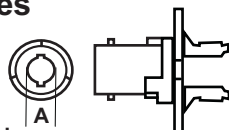

Round Bore Yoke Stock Number	Overrunning Round Bore Yoke Stock Number	A Bore
S.825-6522*	S.826-6522*	1 3/8" Rd

**Bondioli & Pavesi 8 Series**

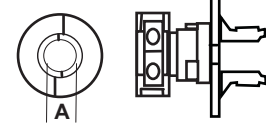

Clamp Yoke Stock Number	Overrunning Clamp Yoke Stock Number	A Bore	Spline
S.817-6820*	S.818-6820*	1 3/4"	20

**Bondioli & Pavesi 5 Series**

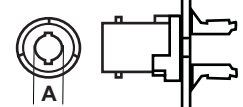

Round Bore Yoke Stock Number	Overrunning Round Bore Yoke Stock Number	A Bore
S.825-6822*	S.826-6822*	1 3/8" Rd

**TORQMASTER Modular Clutch Components**

\* SPECIAL ORDER

**Walterscheid 2400 Series**

Clamp Yoke Stock Number	Overrunning Clamp Yoke Stock Number	A Bore	Spline
S.817-7606*	S.818-7606*	1 3/8"	6
S.817-7621*	S.818-7621*	1 3/8"	21

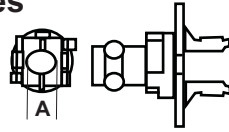

**Walterscheid 2500 Series**

Round Bore Yoke Stock Number	Overrunning Round Bore Yoke Stock Number	A Bore
S.825-7922*	S.826-7922*	1 3/8" Rd

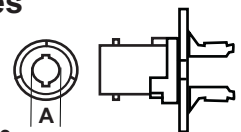

**Walterscheid 2400 Series**

Clamp Yoke Stock Number	Overrunning Clamp Yoke Stock Number	A Bore	Spline
S.817-7620*	S.818-7620*	1 3/4"	20

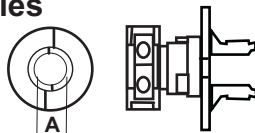

**Spring - 7", 9"**

Stock Number	A O.D.	B Thickness	Color Code
S.987-9000	6.188"	.138"	Blue
S.98712000	6.188"	.158"	Green
S.98715000	6.188"	.169"	Yellow
S.98718000	6.188"	.189"	White
S.98910000	8.00"	.158"	Blue
S.98915000	7.81"	.169"	Yellow
S.98918000	7.87"	.189"	Red

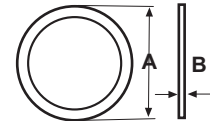

**Walterscheid 2400 Series**

Round Bore Yoke Stock Number	Overrunning Round Bore Yoke Stock Number	A Bore
S.825-7622*	S.826-7622*	1 3/8" Rd

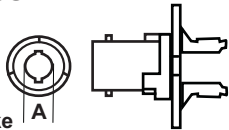

**Separator Plate - 7", 9"**

Separator Plate Stock Number	Overrunning Separator Plate Stock Number	A O.D.	B O.D.
S.990-7000		6.20"	
S.991-7000		6.20"	
S.990-9000		8.07"	
S.991-9000		8.07"	

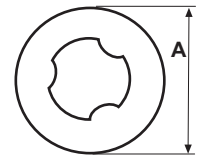

**Walterscheid 2500 Series**

Clamp Yoke Stock Number	Overrunning Clamp Yoke Stock Number	A Bore	Spline
S.817-7906*	S.818-7920*	1 3/8"	6
S.817-7921*	S.818-7921*	1 3/8"	21

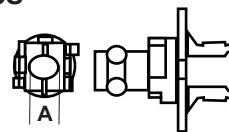

**Overrunning Clutch Repair Kit - 7", 9"**

Stock Number	Contents
S.980-7000	(1) Overrunning Collar (2) Dogs (2) Leaf Springs (1) Wave Spring (1) Washer (1) Retaining Ring (1) Assembly / Disassembly Instructions

**Walterscheid 2500 Series**

Clamp Yoke Stock Number	Overrunning Clamp Yoke Stock Number	A Bore	Spline
S.817-7920*	S.818-7920*	1 3/4"	20

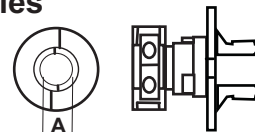

**TORQMASTER Modular Clutch Assembly Instructions**

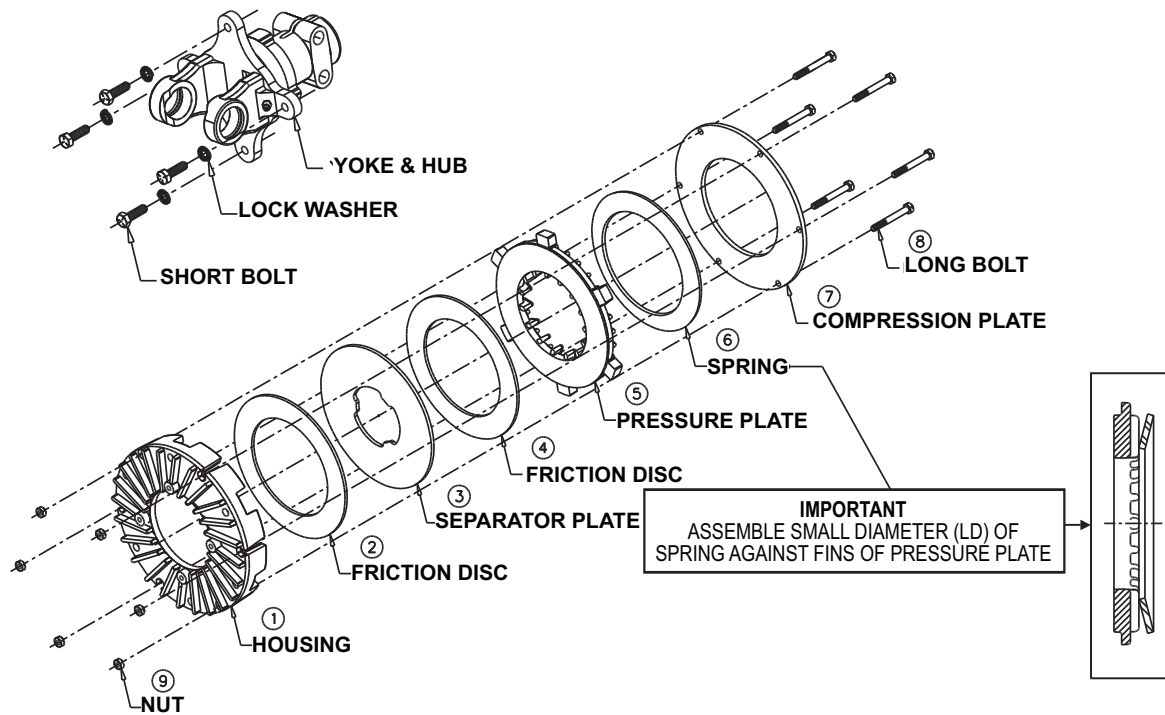

**Modular Clutch Instructions**

**If the clutch has not been operated for (1) season we recommend the following:**

**Tools Required:**

(1) 1/2" box wrench or socket

1. Make sure the tractor is off and the PTO is disengaged.
2. Disconnect the driveline from the tractor.
3. Locate the bolts on the O.D. of the clutch pak.  
Loosen the bolts until all are finger tight, then tighten each one half a turn.
4. Attach the implement to the tractor at the hitch pin, and the driveline to the tractor PTO.
5. Turn the tractor on. Engage the PTO clutch and run for a few seconds, or until the clutch visibly smokes.
6. Disengage the tractor PTO and shut off the tractor.
7. Disconnect the driveline from the tractor.
8. Tighten the bolts on the O.D. of the clutch pak until the compression plate is in full contact with the housing.
9. If the clutch contains an integral overrunning clutch, make sure the clutch spins freely in one direction.

**Clutch Pak Product Information**

Adjustment detail - 7" and 9" Clutch Paks

- No spring adjustment required
- Tighten bolts to 30 ft-lbs (max)

You will find some overlap within an implement category in the Clutch Pak Selection Guide. The operator will generally know if he has a heavy duty or light duty application. If in doubt, always protect the driveline...refer to the 'general guideline for selecting proper clutch pak' In this section.

**80° Constant Velocity Driveline**

**Constant Velocity Driveline Replacement Chart**

Weasler Catagory	Weasler Series	Replacement For
3	14	Bondioli & Pavesi 4 Series Walterscheid 2370 Series
5	44	Bondioli & Pavesi 6 Series Walterscheid 2480 Series
6	55	Bondioli & Pavesi 8 Series Walterscheid 2580 Series

**Ordering Instructions for CV Driveline**

Determine the overall length of the driveline in a closed position. Next select the stock number which closely corresponds with the appropriate series and length. Driveline furnished without Cross & Bearing Kit and Implement Yoke. When Cross & Bearing Kit and implement yoke are assemble, the overall length of driveline will be 48", 67" or 79".

**SPECIAL ORDER PARTS**

The chart lists the approximate size replacement for Constant Velocity Drivelines. These are not an exact interchange and should be used as a general replacement guide only.

**Complete Drivelines**

Stock Number	Series	Shaft Size	A Overall Driveline Length	Max Overall Operating Length	Tractor Yoke
14501448	14	1" x 1 1/8"	48"	67"	1 3/8" x 6
14601448	14	1" x 1 1/8"	48"	67"	1 3/8" x 21
14501467	14	1" x 1 1/8"	48"	86"	1 3/8" x 6
14601467	14	1" x 1 1/8"	48"	86"	1 3/8" x 21
14503548	35	1 11/16" x 20"	48"	67"	1 3/8" x 6
14603548	35	1 11/16" x 20"	48"	67"	1 3/8" x 21
14703548	35	1 11/16" x 20"	48"	67"	1 3/4" x 20
14503567	35	1 11/16" x 20"	67"	84"	1 3/8" x 6
14603567	35	1 11/16" x 20"	67"	84"	1 3/8" x 21
14703567	35	1 11/16" x 20"	67"	84"	1 3/4" x 20
14503579	35	1 11/16" x 20"	79"	96"	1 3/8" x 6
14603579	35	1 11/16" x 20"	79"	96"	1 3/8" x 21
14703579	35	1 11/16" x 20"	79"	96"	1 3/8" x 20
14504448	44	1 11/16" x 20"	48"	67"	1 3/8" x 6
14604448	44	1 11/16" x 20"	48"	67"	1 3/8" x 21
14704448	44	1 11/16" x 20"	48"	67"	1 3/4" x 20
14504467	44	1 11/16" x 20"	67"	84"	1 3/8" x 6
14604467	44	1 11/16" x 20"	67"	84"	1 3/8" x 21
14704467	44	1 11/16" x 20"	67"	84"	1 3/4" x 20
14504479	44	1 11/16" x 20"	79"	96"	1 3/8" x 6
14604479	44	1 11/16" x 20"	79"	96"	1 3/8" x 21
14704479	44	1 11/16" x 20"	79"	96"	1 3/4" x 20
14505548	55	1 11/16" x 20"	48"	67"	1 3/8" x 6
14605548	55	1 11/16" x 20"	48"	67"	1 3/8" x 21
14705548	55	1 11/16" x 20"	48"	67"	1 3/4" x 20
14505567	55	1 11/16" x 20"	67"	84"	1 3/8" x 6
14605567	55	1 11/16" x 20"	67"	84"	1 3/8" x 21
14705567	55	1 11/16" x 20"	67"	84"	1 3/4" x 20
14505579	55	1 11/16" x 20"	79"	96"	1 3/8" x 6
14605579	55	1 11/16" x 20"	79"	96"	1 3/8" x 21
14705579	55	1 11/16" x 20"	79"	96"	1 3/4" x 20

**80° Constant Velocity Driveline**

**Tractor Yokes  
Safety Slide Lock**

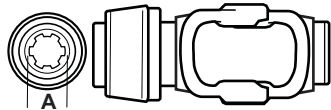

Stock Number	Series	A Bore
107-3506	35/44	1 3/8" x 6
107-3521	35/44	1 3/8" x 21
107-5506	55	1 3/8" x 6
107-3506	35/44	1 3/8" x 6

**Shaft  
1 11/16" x 20 Spline  
Induction Hardened**

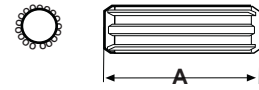

Stock Number	Series	Length
404-2720	35/44/55	3'

**Spring-Lok**

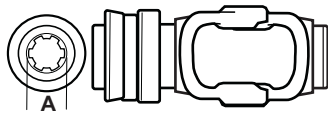

Stock Number	Series	A Bore
108-1406	14	1 3/8" x 6
108-1421	14	1 3/8" x 21

**Center Housing**

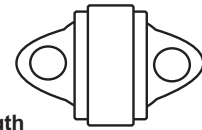

Stock Number	Series	Length
550-1430	14	
550-3545	35/44	
550-5556	55	

**Quick  
Disconnect**

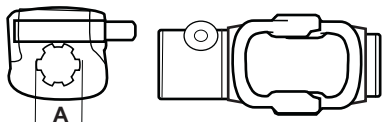

Stock Number	Series	A Bore
109-3506	35/44	1 3/8" x 6
109-3520	35/44	1 3/4" x 20
109-5520	55	1 3/4" x 20

**Yoke & Shaft  
Fits all Corresponding  
Series Tube Assemblies**

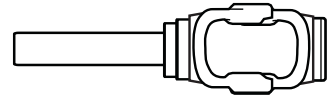

Stock Number	Series	Shaft	Length
10101400	14	1" x 1 1/8" Rect	27 1/4"
10103500	35/44	1 11/16" x 20 Spline	27"
10105500	55	1 11/16" x 20 Spline	27"

**Cross & Bearing Kit**

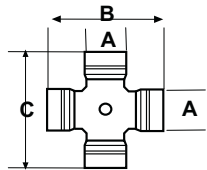

Stock Number	A	B	C	D
200-1430	1 1/8"	2 5/8"	4 1/4"	-
200-3545	1 1/4"	3 7/32"	4 5/16"	-
200-5556	1 5/16"	4 5/16"	3 47/64"	1 17/32"

**Yoke Tube & Sleeve Assembly**

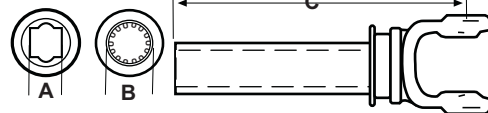

Stock Number	Series	A or B Bore	C Length
11101448	14	1" x 1 1/8" Rect	48"
11101467	14	1" x 1 1/8" Rect	67"
11103548	35	1 11/16" x 20 Spline	48"
11103579	35	1 11/16" x 20 Spline	79"
11104448	44	1 11/16" x 20 Spline	48"
11104467	44	1 11/16" x 20 Spline	67"
11104479	44	1 11/16" x 20 Spline	79"
11105548	55	1 11/16" x 20 Spline	48"
11105567	55	1 11/16" x 20 Spline	67"
11105579	55	1 11/16" x 20 Spline	79"

**Shaft  
1 x 1 1/8" Rectangular**

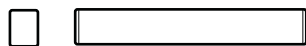

Stock Number	Series	Length
400-1618	14	6'

80° Constant Velocity Driveline

Joint & Shaft

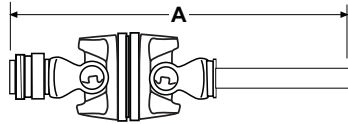

Stock Number	Series	Shaft	Length
15501406	14	1" x 1 1/8" Rect	27 1/4"
15601421	14	1" x 1 1/8" Rect	27 1/4"
15503506	35/44	1 1/16" x 20 Spline	27"
15603521	35/44	1 1/16" x 20 Spline	27"
15703520	35/44	1 1/16" x 20 Spline	27"
15505506	55	1 1/16" x 20 Spline	27"
15605521	55	1 1/16" x 20 Spline	27"
15705520	55	1 1/16" x 20 Spline	27"

Joint & Half Shaft with Guard

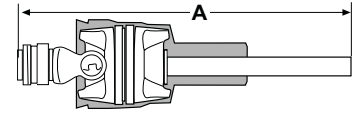

Stock Number	Series	Shaft	Length
16501406	14	1" x 1 1/8" Rect	27 1/4"
16601421	14	1" x 1 1/8" Rect	27 1/4"
16503506	35/44	1 1/16" x 20 Spline	27"
16603521	35/44	1 1/16" x 20 Spline	27"
16703520	35/44	1 1/16" x 20 Spline	27"
16505506	55	1 1/16" x 20 Spline	27"
16605521	55	1 1/16" x 20 Spline	27"
16705520	55	1 1/16" x 20 Spline	27"

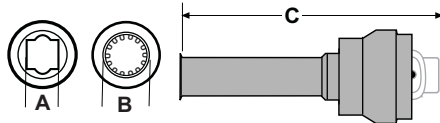

Yoke, Tube & Sleeve with Guard

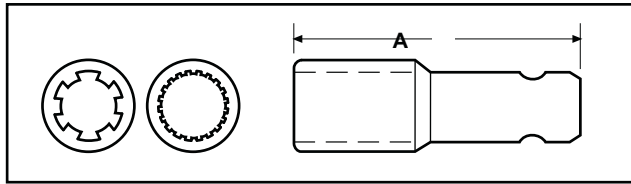

Stock Number	Series	A or B Bore	C Length
17501448	14	1" x 1 1/8" Rect	48"
17501467	14	1" x 1 1/8" Rect	67"
17503548	35	1 1/16" x 20 Spline	48"
17503567	35	1 1/16" x 20 Spline	67"
17503579	35	1 1/16" x 20 Spline	79"
17504448	44	1 1/16" x 20 Spline	48"
17504467	44	1 1/16" x 20 Spline	67"
17504479	44	1 1/16" x 20 Spline	79"
17505548	55	1 1/16" x 20 Spline	48"
17505567	55	1 1/16" x 20 Spline	67"
17505579	55	1 1/16" x 20 Spline	79"

**PTO Adaptors**



Adaptor Type	Female Spline		Male Spline		Increases PTO Shaft Length by ins	Overall Length A ins	Part Number
	Ø F		Ø M				
Extension Adaptors	1 3/8"	x 6	1 3/8"	x 6	4"	5 3/4"	S.00255 S.00254
					7"	9 7/16"	
Universal Reducer	1 3/8"	x 6	1 1/8"	x 6	2 7/8"	5 3/8"	S.00251
Converters	1 3/4"	x 20	1 3/8"	x 6 x 21	5"	7 3/8"	S.08443 S.08441
Heavy Duty Increasers	1 1/8"	x 6	1 3/8"	x 6 x 21	2 3/4" 3"	4 3/4"	S.00252
Adaptor Assembly Fits Compact Tractors	1"	x 18	1 3/8"	x 6	3"	5"	S.15073

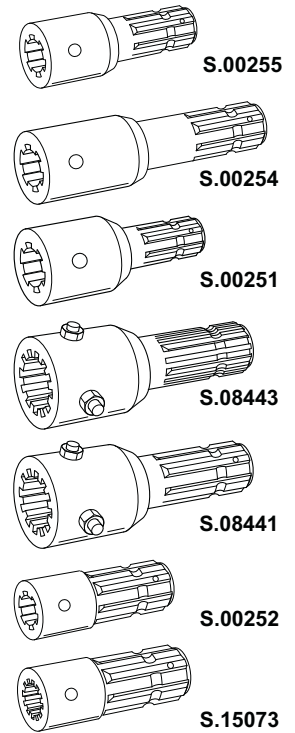

**Sleeve Increasers**

Female Spline		Male Spline		Overall Length A ins	Part Number
Ø F		Ø M			
1 1/8"	x 6	1 3/8"	x 6	2 3/16" 3 3/16"	S.00249 S.00253*

\*Less S.00248 Roll Pin

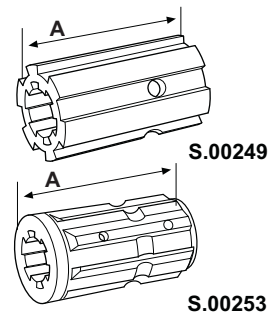

Quick Disconnect Push Pin Adaptors

Quick Release Type

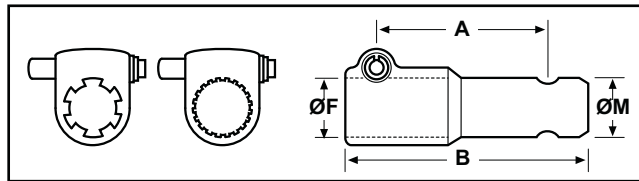

Female Spline Ø F	Male Spline Ø M	Increases P.T.O. Shaft Length by	Overall Length	Quick Release Type Part Number	
				Standard Up to 70 h.p	Heavy Duty Over 70 h.p
1 1/8" x 6	1 3/8" x 6	4 5/16"	6 1/2"	S.15720	-
1 3/8" x 6	1 3/8" x 6	4 5/16"	6 1/2"	S.03737	S.15901
	1 3/8" x 21	4 3/4"		S.13393	S.15903
	1 1/8" x 6	5 1/8"		S.15678	-
1 3/8" x 21	1 3/8" x 6	4 5/16"	6 1/2"	S.13380	S.15865
	1 3/8" x 21	4 3/4"		S.03740	S.15907
	1 1/8" x 6	5 1/8"		S.15727	-
1 3/4" x 6	1 3/8" x 6	5"	7 7/8"	-	S.16245
	1 3/8" x 21	5 1/2"		-	-
1 3/4" x 20	1 3/8" x 6	5 1/2"	7 7/8"	-	S.16247
	1 3/8" x 21	5 1/2"		-	-

Quick Disconnect Adaptor

Rotating Lock Collar Type -  
Up to 75hp  
Black

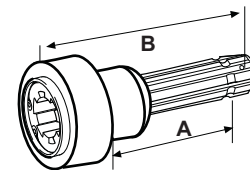

Female Spline Ø F	Male Spline Ø M	Increases P.T.O. Shaft Length by	Overall Length	Quick Release Type Part Number	
				Standard Up to 70 h.p	Heavy Duty Over 70 h.p
1 3/8" x 6	1 3/8" x 21	3 1/2"	6 1/2"	S.13377	-
1 3/8" x 21	1 3/8" x 21	3 1/2"	6 1/2"	S.13379	-

**Bolt Adaptors**

**Bolt Type**

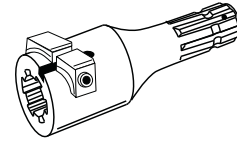
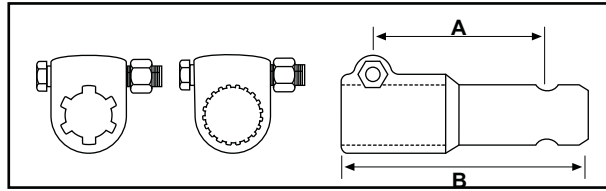

- + 1 Bolt
- \* 1 Allen Head Bolt
- \*\* 2 Allen Head Bolts



Female Spline Ø F	Male Spline Ø M	Increases P.T.O. Shaft Length by		Overall Length		Bolt Type Part Number	
		A ins	B ins	Standard Up to 70 h.p	Heavy Duty Over 70 h.p		
1 3/8" x 6	1 3/8" x 6	4 5/16"	6 1/2"	S.03741	S.15902		
	1 3/8" x 21	4 3/4"		S.03742	S.15904		
	1 1/8" x 6	5 1/8"		-	-		
1 3/8" x 21	1 3/8" x 6	4 5/16"		S.03743+ S.13381*	S.15866		
	1 3/8" x 21	4 3/4"		S.03744	-		
	1 1/8" x 6	5 1/8"		-	-		
1 1/8" x 6	1 3/8" x 6	4 5/16"	6 1/2"	-	-		
	1 3/8" x 21	4 3/4"		-	-		
	1 1/8" x 6	5 1/8"		S.15723	-		
1 3/4" x 6	1 3/8" x 21	5 1/2"	7 7/8"	-	-		
	1 3/8" x 6	5"		-	S.16249		
1 3/4" x 20	1 3/8" x 21	5 1/2"		S.13372*	S.13371**		
	1 3/8" x 6	5"		S.13374*	S.16251+ S.13373**		

Special Adaptors

PTO Overrunning Coupler - Black

Female Spline ins		Male Spline ins		Increases P.T.O Shaft Length by ins	Part Number
1 1/8"	x 6	1 1/8"	x 6	4 3/8"	S.13376
1 1/8"		1 3/8"			S.15451
1 3/8"		1 1/8"			S.13375
1 3/8"		1 3/8"			S.15514

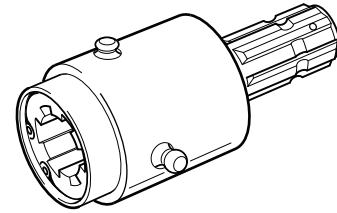

General Purpose and Pump Adaptors

Female Spline Ø F ins		Ø A ins	Ø B ins	Overall Length L ins	Part Number
1 3/8"	x 6	5/8"	1 3/8"	4 5/8"	S.04981
		3/4"			S.04982
		1"			S.04984

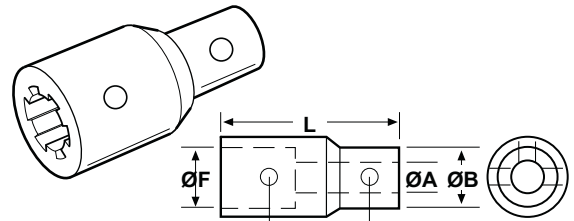

21/64" 8.3mm C  
C = 3/8" UNC holes fitted with set screws.

Push Button Sleeve

S.04467

Ø F = 1 3/8" x 6 Splines

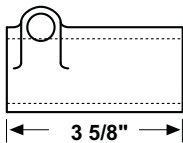
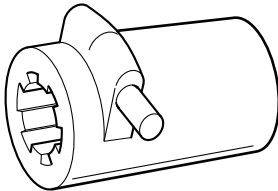

Quick Release Adaptor

S.15229

Ø F = 1 3/8" x 6 Splines

Ø A = .944"/.946"

Ø B = Fitted with set screws

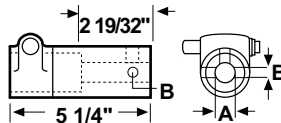
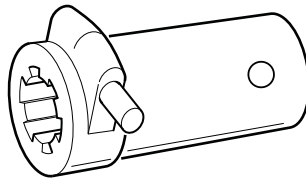

Splined Couplings

Female Spline ins		Overall Length L ins	Part Number
1 1/8"	x 6	2 3/4"	S.00286
1 3/8"		3 3/4"	S.00287
1 3/4"	x 20		S.15731
			S.15733

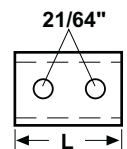
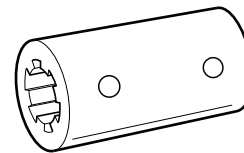

**Splined Shafts**

**Splined Shafts - 6 Spline**

Spline Ø	No. of Splines	B	C	D	E	Part Number
1 3/8"	6	5 7/8"	2 61/64"	1 1/2"	1 3/8"	S.16426
		13 3/4"				S.16427

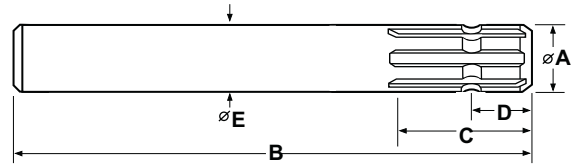

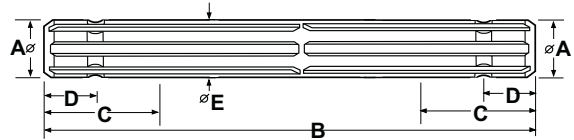

**Splined Shafts - 6 Spline**

Spline Ø	No. of Splines	B	C	D	E	Part Number
1 3/8"	6	11 13/16"	3"	1 1/2"	1 3/8"	S.16428
		5 7/8"				S.16615



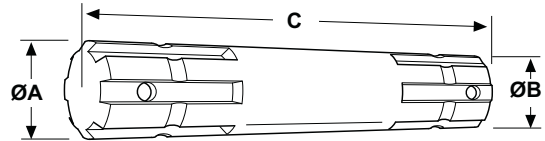

**Extension Shafting - 6 Spline**

Ø A		Ø B		Length C	Part Number
ins		ins			
1 3/8"	x 6	1 1/8"	x 6	9"	S.00278
		1 3/8"			S.00279



**Repair Shafting - 6 Spline**

Ø A		Length B	Part Number
ins		ins	
1 3/8"	x 6	10"	S.00283

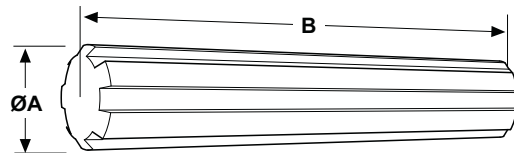

Easy Lock Safety Guards



- New Series of High Specification Safety Guards
- Approved to CEN 1152
- Fits North American and Metric Drive Shafts

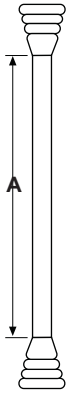

A	250	350	450
29.50" 750mm	S.59605	S.59613	S.59621
39.25" 1000mm	S.59606	S.59614	S.59622
51.125" 1300mm	S.59607	S.59615	S.59623

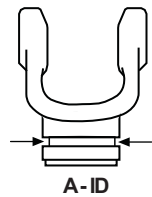
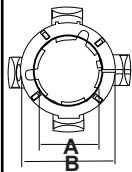
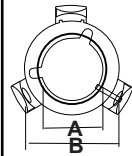

BEARING KITS (w/ Nipple Locks S.56509 x 2)					
TYPE A - 250 - NORTH AMERICAN					
STOCK NO	SERIES	GUARD	A - ID	A - ID	B - OD
S.22566	6	250	46.4mm/1.83"	46.4mm/1.83"	71.4mm/2.81"
S.22567	12, 14, 35	250	52.8mm/2.08"	52.8mm/2.08"	71.4mm/2.81"
S.22568	W	250	41.8mm/1.65"	41.8mm/1.65"	71.4mm/2.81"
TYPE A - 250 - METRIC					
STOCK NO	SERIES	GUARD	A - ID	A - ID	B - OD
S.56550	BP A1	250	34mm/1.36"	40mm/1.59"	71.4mm/2.81"
S.59635	BP A2	250	40mm/1.59"	47mm/1.87"	71.4mm/2.81"
S.59636	BP A3, A4	250	47mm/1.87"	54mm/2.10"	71.4mm/2.81"
S.56500	W 2100, 2200	250	41mm/1.63"	41mm/1.63"	71.4mm/2.81"
S.59631	W 1, 2200, 2300	250	50mm/2.00"	50mm/2.00"	71.4mm/2.81"
TYPE B - 350 - NORTH AMERICAN					
STOCK NO	SERIES	GUARD	A - ID	A - ID	B - OD
S.22569	44, 55	350	67.2mm/2.65"	67.2mm/2.65"	83.6mm/3.29"
TYPE B - 350/450 - METRIC					
STOCK NO	SERIES	GUARD	A - ID	A - ID	B - OD
S.59637	BP A5	350	54mm/2.11"	62mm/2.47"	83.6mm/3.29"
S.59638	BP A6, A7, A8	350	60mm/2.34"	68mm/2.69"	83.6mm/3.29"
S.59639	BP A9, A10	450	68mm/2.69"	80mm/3.17"	103mm/4.05"
S.59632	W 11, 220, 240, 2300, 2400, 2500	350	63mm/2.46"	63mm/2.46"	83mm/3.27"
S.59633	W 2600	450	82mm/3.26"	82mm/3.26"	103mm/4.05"
WIDE ANGLE GUARDS					
A	2380 SERIES	2480 SERIES	S.56509 (Use 2 per Guard)		
29.50" 750mm	S.59624	S.59628			
39.25" 1000mm	S.59625	S.59629			
BEARING KITS (w/ Nipple Locks S.56509 x 2)					
STOCK NO	SERIES	A - ID	A - ID	B - OD	
S.59632	W 2480	63mm/2.5"	63mm/2.5"		
S.59644	W 2380	50mm/1.97"	50mm/1.97"		