

9 3-POINT LINKAGE

3-Point Linkage Definition of Categories



Top Link

Cat 0	5/8"	16mm
Cat 1	3/4"	19mm
Cat 2	1"	25mm
Cat 3	1 1/4"	32mm

Lower Link

Cat 0	5/8"	16mm
Cat 1	7/8"	22mm
Cat 2	1 1/8"	28mm
Cat 3	1 7/16"	36mm

The linkage of a tractor is often described in terms of Category 0, 1, 2 or 3. The table above shows the dimensions which correspond to these Categories.

Top Link Holder

Manufactured from spring steel, this retaining clip will keep the top link securely in place while not in use. It can be bolted on to any convenient position.

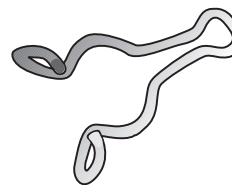

S.14341

1 pc

Standard Duty Top Links

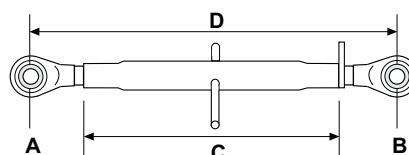
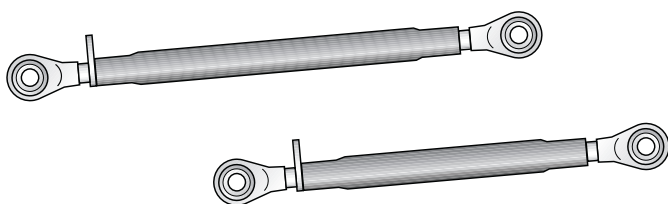

Max HP: 50

S.00333 Tommy Bar

S.00348 1/8" UNC L/Collar

Cat	Tube Length		Standard Duty Top Links					Adjustment				Replacement Ball Ends	
	ins	mm	Zinc	Blue	Green	Red	Gold (Economy)	ins		mm		LH	RH
								Min	Max	Min	Max		
0/0	7 1/2	190	-	-	-	S.04418	-	11 1/32	15 15/32	280	393	S.04422	S.04423
0/0	9 3/4	248	-	-	-	S.04419	-	12 19/32	17 27/32	320	453	S.04422	S.04423
1/1	7	180	S.15502	-	-	-	-	11 5/8	14 9/16	295	370	-	-
1/1	9	230	-	-	-	-	S.13276	13	19	345	470	-	-
1/1	11 1/4	285	S.00306	-	-	-	S.49306	16 1/32	23 7/16	407	595	-	-
1/1	13	330	-	S.00481	-	S.00480	S.49479	17 17/32	25 15/32	445	647	S.00342	S.00343
1/1	14 1/2	368	-	-	-	-	S.49363	19 3/32	27 1/32	485	687	S.00342	S.00343
1/1	16	406	-	S.00300	S.03387	S.00334	S.49312	20 15/32	28 7/16	520	722	S.00342	S.00343
1/2	16	406	S.49315	S.00304	-	-	-	20 23/32	28 21/32	526	728	S.00342	S.00347
2/2	16	406	-	-	-	-	S.49314	20 15/16	32 3/32	532	815	S.00346	S.00347
1/1	20	508	-	S.00301	-	S.00335	S.49316	24 19/32	32 9/16	625	827	S.00342	S.00343
1/2	20	508	-	-	-	-	S.49319	24 27/32	32 25/32	631	833	S.00342	S.00347
2/2	20	508	-	-	-	-	S.49318	25 3/32	36 7/32	657	920	S.00346	S.00347

SEE SECTION 2/PAGES 2 & 4 FOR LOCKING & LYNCH PINS

Forged Top Link Ends

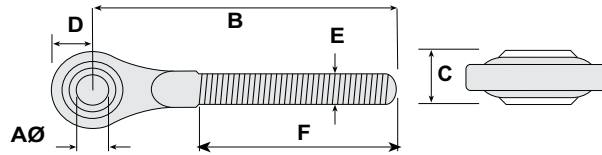

Cat	E Ø UNC	ins	A Ø mm	ins	B mm	ins	C mm	ins	D mm	ins	F mm	End	Part No.
Standard Duty													
0	3/4	5/8	16	5 1/8	130	1	25.4	7/8	22	3 15/16	100	LH	S.04422
0	3/4	5/8	16	5 1/8	130	1	25.4	7/8	22	3 15/16	100	RH	S.04423
1	1 1/8	3/4	19	7 3/4	197	1 3/4	44.5	1 1/8	28.6	5 5/8	143	LH	S.00342
1	1 1/8	3/4	19	7 3/4	197	1 3/4	44.5	1 1/8	28.6	5 5/8	143	RH	S.00343
2	1 1/8	1	25.4	9 3/4	247	2	50.8	1 5/16	33	7 3/8	187	LH	S.00346
2	1 1/8	1	25.4	9 3/4	247	2	50.8	1 5/16	33	7 3/8	187	RH	S.00347
Heavy Duty													
2	1 1/4	1	25.4	10 5/8	270	2	50.8	1 1/2	38	6 11/16	170	LH	S.04109
2	1 1/4	1	25.4	10 5/8	270	2	50.8	1 1/2	38	6 11/16	170	RH	S.03942
Extra Heavy Duty													
2	1 1/4	1	25.4	10	254	2	50.8	1 27/32	47	7 1/4	185	LH	S.03246
2	1 1/4	1	25.4	10	254	2	50.8	1 27/32	47	7 1/4	185	RH	S.03244
3	1 3/8	1 1/4	31.7	10 1/4	260	1 3/4	44.5	1 3/4	44.5	7 1/4	185	LH	S.04951
3	1 3/8	1 1/4	31.7	10 1/4	260	1 3/4	44.5	1 3/4	44.5	7 1/4	185	RH	S.04950

Top Links

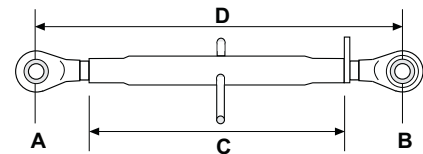
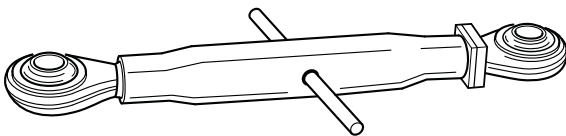

Cat 2 Heavy Duty Top Links

	A		B		C		D			Part No.	LH End	RH End	Color	HP
	mm	ins	mm	ins	mm	min	ins	max	min-mm-max					
1	25	1	25	19	483	24 7/16	35 1/4	621	897	S.04108	S.04109	S.03942	Red	75
1	25	1	25	15	381	22 1/8	32 7/16	562	824	S.03473	S.03246	S.03244	Red	110
1	25	1	25	19	483	26 5/32	36 9/16	664	929	S.03474	S.03246	S.03244	Red	110

Please ensure that the tractor has at least 1 1/4" 32mm between the Top Link Pin and the Tractor Housing.

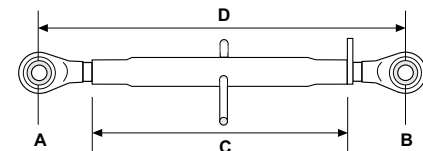
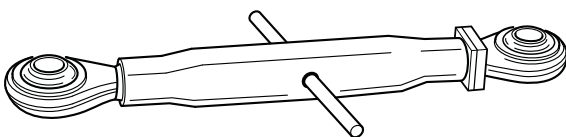

Cat 3 Heavy Duty Top Link - Max.HP:110

	A		B		C		D			Part No.	LH End	RH End	Center Tube	Color
	ins	mm	ins	mm	ins	mm	ins	mm	max					
							min	min	max					
1 1/4	32	1 1/4	32	19	483	25 1/2	648	927	S.04603	S.04951	S.04950	S.04949	Black	

9 3-POINT LINKAGE

Cat 2 & 3 Special Heavy Duty Superlinks

- Center tube, stove enamelled black gloss
- Ball Ends and Locking Collar BZP
- 2 Greasing Points
- Extra strong one side swagged ball sockets forged from carbon manganese steel
- Case hardened swivel balls

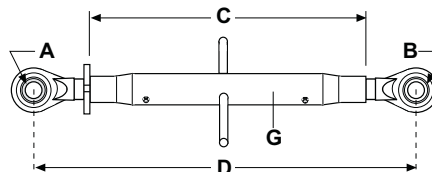
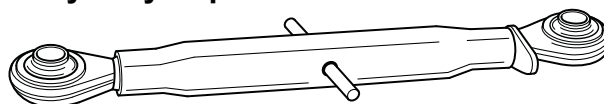

Sparex Part No.	A/B	C		D		Ball End LH Thread M36	Ball End RH Thread M36	Thread
	Cat	ins	mm	Min/Max	inch			
S.16073	2/2	15	380	515	781	S.16076	S.16075	1 1/4" UNC
S.16074	2/2	19	485	620	886	S.16076	S.16075	1 1/4" UNC
S.16840	3/3	15	380	20 5/8	32 1/8	S.16848	S.16849	M36-3
S.16843	3/3	19	485	24 3/8	35 5/8	S.16848	S.16849	M36-3

David Brown Top Links

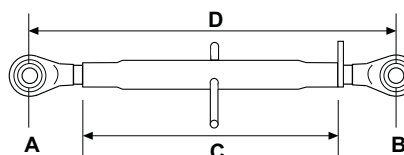
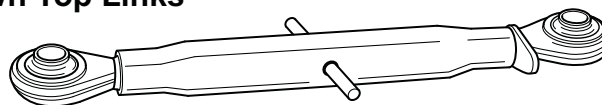

Cat	D		Part No.	Color	Models
	min	max			
1/2	20	30	S.00387	Zinc	780, 880

Supplied with Bushing S.00407

Ford Top Links

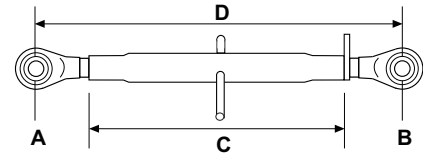
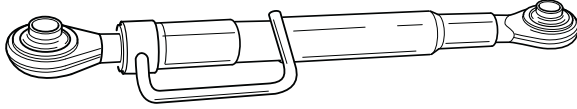

Cat	D inch		Part No.	LH End	RH End	Color	Replaces
	min	max					
1	24 1/2	31 1/4	S.11878	S.03633	S.11877	Blue	D0NN576B
1/2	24 1/2	31 1/4	S.03630	S.03633	S.03632	Blue	E6NN576C
2/2	24 1/2	31 1/4	S.03631	S.03634	S.03632	Blue	D0NN576A

Ford Top Link Ends

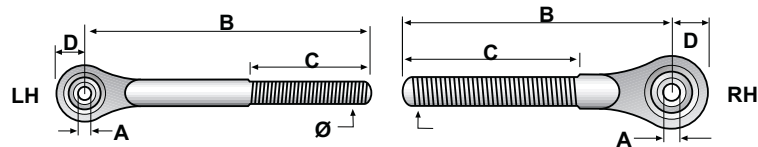

Cat	A inch	B inch	C inch	D inch	ØE UNC	End	Part No.	Replaces
1	3/4	13 1/4	5	1 1/2	1 1/4	LH	S.03633	D0NN A914A
2	1	13 1/4	5	1 1/2	1 1/4	LH	S.03634	D0NN A914B
1	3/4	10	6 5/8	1 1/2	1 1/4	RH	S.11877	D6NN A911A
2	1	10	6 5/8	1 1/2	1 1/4	RH	S.03632	D0NN A911A

Compact Top Links

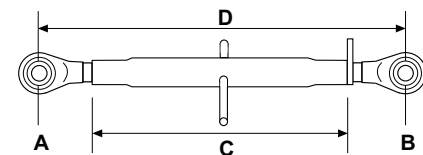
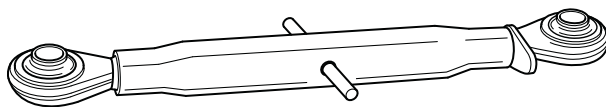

Iseki, Kubota & other Compact Tractors Top Link - Ball Ends narrower than standard Top Links

Cat	D inch		Part No.	Center Tube	Color	Models
	min	max				
1/1	20 1/2	32 1/2	S.04718	14 1/2	Zinc	Various
1/1	18	26	S.42864	13 1/2	Black	Various

9 3-POINT LINKAGE

John Deere Top Links

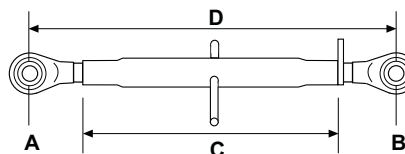
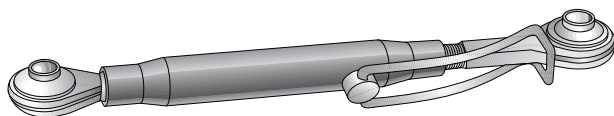

	D inch		Part No.	LH End	RH End	Color	Replaces
	min	max					
	21 5/8	30	S.04261	S.04262 1 1/8" UNC .787" Ø	S.04263 1 1/8" UNC 1" Ø	Green	S-AL 39170
	25	31 1/2	S.17841	S.04263 1 1/8" UNC 1" Ø	S.04263 1 1/8" UNC 1" Ø	Green	

John Deere Top Link Ends

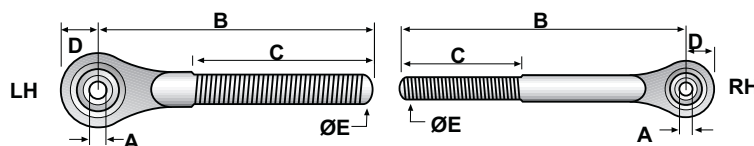

A		B		C		D		ØE UNC	End	Part No.	Replaces
inch	mm	inch	mm	inch	mm	inch	mm				
25/32	20	9 7/16	239	7 3/4	197	1 3/8	35	1 1/8	LH	S.04262	S-AL 39172
1	25.4	12 1/4	311	5 3/4	146	1 3/8	35	1 1/8	RH	S.04263	S-AL 39171

(S.04261 only)

John Deere Top Links

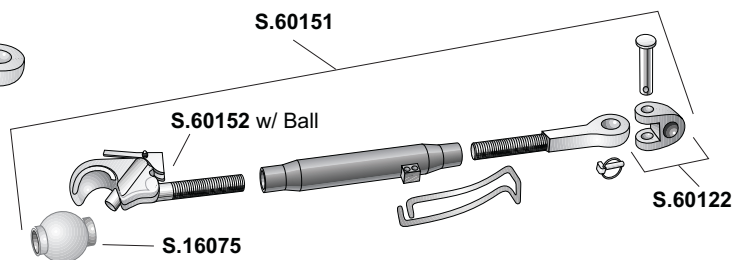
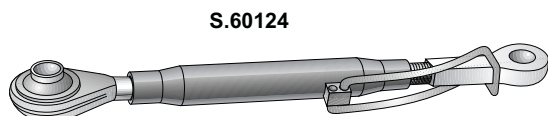

Cat 2 Heavy Duty Top Links

D		Part No.	LH End	RH End	Color	Knuckle	Clevis Pin	Clip	Replaces
inch	mm								
min	max	min	max						
22	29 3/4	S.60124	S.60122	S.16075	Green	-	-	S.04264	
22 3/4	30	S.60151	S.60122	S.60152	Green	S.60123	S.17410	S.04264	S-AL 68208

Massey Ferguson Top Links

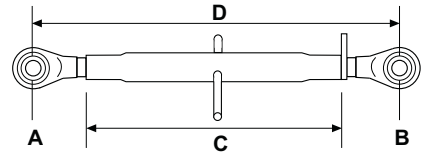
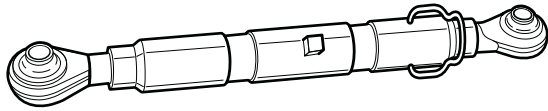

Cat	D		Part No.	LH End	RH End	Clip	Color	Replaces
	min	max						
1/1	23 1/4	29 1/2	S.00584	S.00448	S.00449	S.00439	Grey	184134M91
1/1	24	30 1/4	S.00585	S.00448	S.00449	S.00439	Grey	184078M91
1/1	26 1/2	33	S.00586	S.00448	S.00449	S.00439	Grey	184361M91
1/2	24	30 1/4	S.00589	S.00448	S.00443	S.00439	Grey	194376M91
1/2	26 1/2	33	S.00588	S.00448	S.00443	S.00439	Grey	894377M91
2/2	26 1/2	33	S.00587	S.00442	S.00443	S.00439	Grey	1887285M91

Massey Ferguson Top Link Ends

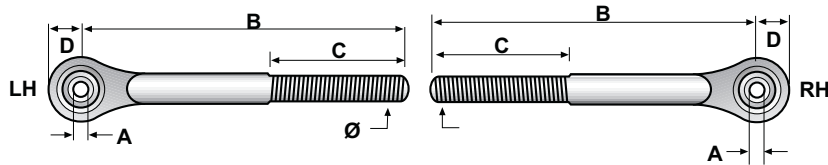

Cat	A	B	C	D	Ø E UNF	End	Part No.	Replaces
	ins	ins	ins	ins				
1	3/4	11 5/8	5	1 1/8	1 1/16	LH	S.00448	183619M92
2	1	11 5/8	5	1 5/16	1 1/16	LH	S.00442	183615M93
1	3/4	11 5/8	5	1 1/8	1 1/16	RH	S.00449	184079M91
2	1	11 5/8	5	1 5/16	1 1/16	RH	S.00443	183623M93

Zetor Top Link

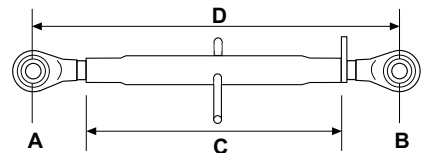
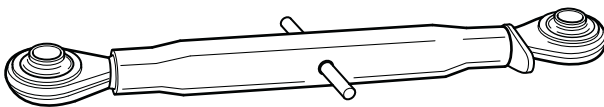

Cat	D		Part No.	LH End	RH End	Center Tube	Color	Models
	min	max						
2/2	20 15/16	32 3/32	S.00297	S.00292	S.00293	S.00330	Zinc	Various

9 3-POINT LINKAGE

Top Link Pin Assortment



S.02304

30pcs

Contains:

S.00073	Cat 1	6
S.00109	22mm	3
S.00074	Cat 1	6
S.00077	Cat 1	3
S.00079	Cat 2	3
S.00069	Cat 2	3
S.00081	Cat 2	3
S.00080	Cat 2	3
S.05804	4" Hook	6
S.05805	6" Hook	2

Top Link Conversion Pin

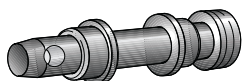

Cat 1-2

Contains:

S.00075 - Pin x 1	S.03872
S.00354 - Bushing x 2	1

Top Link Pin

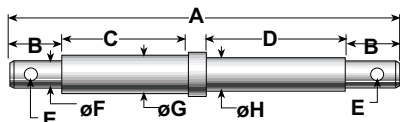

S.05008

A=8 3/4", B=1 1/4", C=2 3/4",
D=2 3/4", E=11/32",
F=11/16", G= 1", H=3/4"

Vicon Top Link Pin

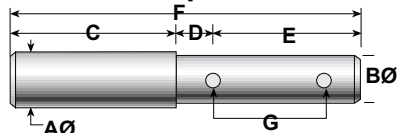

S.03540

A=1 7/64", B=7/8",
C=3 17/32", D=21/32",
E=2 3/8", F=7 5/64", G=1/4"ø

Top Link Pins

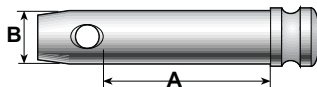

Cat 0

S.15010	A	B
S.03173	2"	5/8"
	3"	5/8"

Cat 1

S.00231	A	B
S.00073	2 3/4"	3/4"
S.00075	3 3/8"	3/4"
S.00074	3 3/4"	3/4"
S.00077	4 3/4"	3/4"

Cat 2

S.00079	A	B
S.00076	3"	1"
S.00069	3 9/16"	1"
S.00081	3 1/2"	1"
S.00081	4 1/16"	1"
S.00080	5 1/4"	1"

Cat 3

S.03026	A	B
S.12336	4 5/8"	1 1/4"
	5 1/4"	1 1/4"

Top Link Pins - Metric

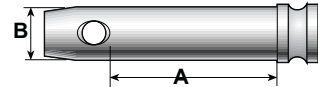

S.00423

A=77mm, B=20mm

S.00078

A=35mm, B=22mm

S.00109

A=75mm, B=22mm,

S.00072

A=144mm, B=22mm

Loader Top Link Pins

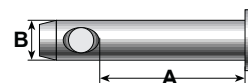

S.02630

A=3 3/4", B=3/4"

S.02631

A=3 3/4", B=3/4"

S.02632

A=5 7/8", B=3/4"

Loader Top Link Pins

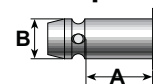

S.03734

A=2", B=1 1/8"

Top Link Pins - Misc

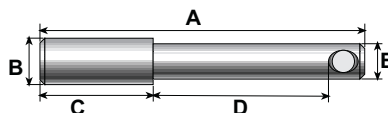

S.15127

A=6 57/64", B=1", C=2 3/8",
D=3 1/4", E=3/4"

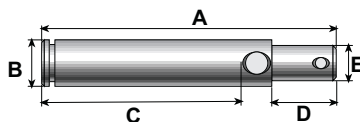

S.00110

A=6 3/16", B=1", C=4 1/8",
D=9/32", E=3/4"

Top Link Pins - Misc

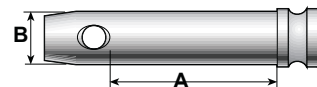

S.05033

A=3 1/2", B=1 1/8"

S.00112

A=6", B=1 1/8"

Universal Top Link Pin

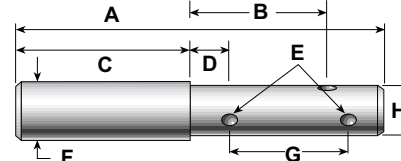

S.03539

A=6 1/2", B=2 9/16", C=3 11/32",
D=45/64", E=3/16"ø, F=1", G=2", H=3/4"

Top Link Swivel Set

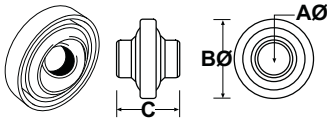

- S.15149 - Cat 0**
A=5/8", B=2", C=1"
- S.15151 - Cat 1**
A=3/4", B=1 7/8", C=1 3/4"
- S.15153 - Cat 2**
A=1", B=2 3/8", C=2"

Top Link Ball Ends

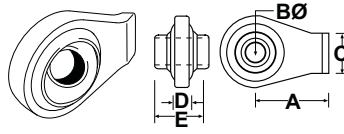

- S.00310 - Cat 1**
A=2", B=3/4", C=1 1/8"
D=1/2", E=1 3/4"
- S.00311 - Cat 2**
A=2 3/8", B=1", C=1 1/8",
D=5/8", E=2"
- S.04216 - Cat 3**
A=3 11/32", B=1 1/4"
C=1 13/32", D=7/8", E=2"

Lower Link Ball End

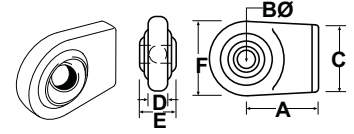

- S.01338 - Cat 1**
A=2 3/4", B=7/8", C=2 3/8"
D=5/8", E=1 3/8", F=2 5/8"
- S.01342 - Cat 2**
A=3 1/8", B=1 1/8", C=2 3/4"
D=3/4", E=1 1/2", F=3 1/4"
- S.01340**
A=3 1/8", B=1", C=2 3/4"
D=3/4", E=1 1/2", F=3 1/4"

Lower Link Ball End

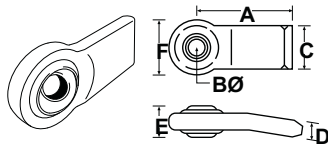

- S.15306 - Cat 1**
A=4", B=7/8", C=1 13/16"
D=5/8", E=1 3/8", F=2 5/8"
- S.15307 - Cat 2**
A=4", B=1 1/8", C=1 13/16"
D=5/8", E=1 3/8", F=3 1/8"

Lower Link Ends

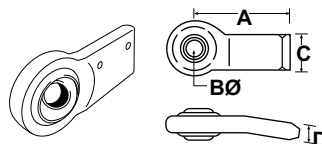

- S.15340 - Cat 1**
A=3 3/4", B=7/8"
C=1 3/4", D=5/8"
 - S.15341 - Cat 1**
A=3 3/4", B=7/8"
C=1 3/4", D=5/8"
- Fits: Ford, MF Lift Arm
LH=Rear Implement RH=Front Tractor
- Fits: Ford, MF Lift Arm
LH=Front Tractor RH=Rear Implement

Lower Link Dual End

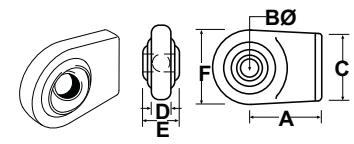

- S.03270 - Cat 1 & 2**
A=3 1/8", B=7/8"
C=2 3/4", D=3/4"
E=1 3/4", F=3 5/8"

Swivel Ball

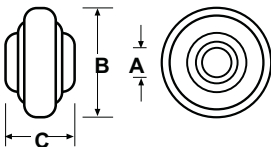

- S.15155 - Cat 1**
A=7/8", B=2 5/8", C=1 3/8"
- S.15157**
A=1", B=3 1/8", C=1 1/2"
- S.15159 - Cat 2**
A=1 1/8", B=3 1/8", C=1 3/4"

Lower Link Ball End

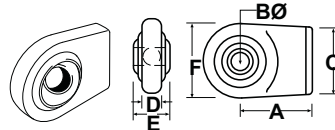

- S.03373 - Cat 1**
A= 3 1/8", B=7/8", C=2 3/4",
D=3/4", E=1 3/8", F=3 5/8"
- S.03374 - Cat 2**
A= 3 1/8", B=1 1/8", C=2 3/4",
D=3/4", E=1 3/8", F=3 5/8"

Lower Link Ball End

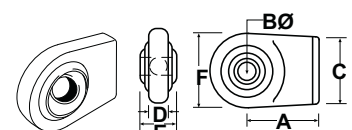

- S.08532 - Cat 2**
A=3 1/4", B=1 1/8", C=3 15/16",
D=7/8", E=1 3/4", F=3 15/16"
- S.04215 - Cat 3**
A=3 1/4", B=1 7/16", C=3 15/16",
D=7/8", E=1 3/4", F=3 15/16"

**Lower Link Ball End
With Heat Treated Swivel Balls**

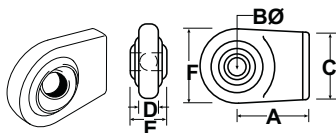

- S.05887 - Cat 1**
A=3", B=7/8", C=2 1/4",
D=11/16", E=1 3/8", F=2 5/8"
- S.05888 - Cat 2**
A=3 1/8", B=1 1/8", C=2 3/4",
D=7/8", E=1 3/4", F=3 1/8"

9 3-POINT LINKAGE

Ford Replacement Balls

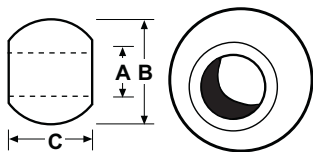

S.00056 - Cat 1
(A=7/8", B=2 1/4", C=1 3/8")
Replaces: E1ADDN995233

S.03057 - Cat 2
(A=1 1/8", B=2 1/4", C=1 3/8")
Replaces: C5NN557B

S.00057 - Cat 2
(A=1 1/8", B=2 1/4", C=1 3/4")
Replaces: C5NN557A



S.04127

S.00056 **2**

S.04128

S.00057 **2**

Ford Ball Retaining Clip

S.00127
Use w/ S.00056, S.03057, S.00057
Fits: Most Ford Tractors ('65>)
Replaces: C5NN557B



S.00128
Use w/ S.01611
Fits: Use w/ Dual Ball Only

Ford Replacement Balls

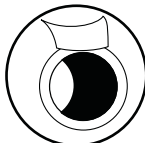

S.18390 - Cat 2
Replaces: 9971701
Fits: TN Series

Ford Dual Category Balls



S.01611 - Cat 1-2 (1 Ball & Clip)



S.01612

S.01611 **10**



S.03224

S.01611 **2**

JD Replacement Balls

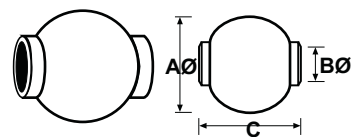

S.15353 - Cat 2 Leveling Arm
(A=1 13/16", B=3/4", C=1 3/8")
Replaces: T21901

S.03054 - Cat 1 Top Link
(A=2", B=3/4", C=1 3/4")
Replaces: F2680

S.03055 - Cat 2 Top Link
(A=2", B=1", C=1 3/4")
Replaces: F2681

MF Dual Category Balls



S.02997 - Cat 1 & 2
Replaces: MF 886428M1, 886429M1



S.03202

10



S.03223

2

Oliver Replacement Balls

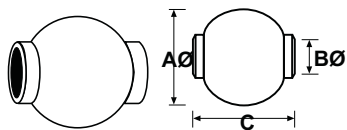

S.15354 - Cat 2 Lift Arm
(A=2", B=1 1/8", C=1 3/4")
Replaces: 104591A

S.03054 - Cat 1 Top Link
(A=2", B=3/4", C=1 3/4")
Replaces: 104585A

S.03055 - Cat 2 Top Link
(A=2", B=1", C=1 3/4")
Replaces: 105968A

Oliver Replacement Balls w/ Cat 3 Hitch

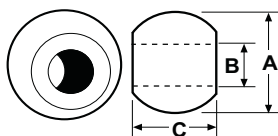

S.33006 - Cat 2
(A=2 1/2" x B=1 1/8" x C=1 3/4")

S.33007 - Cat 3
(A=2 1/2" x B=1 1/2" x C=1 3/4")

Replaces: 165045A, 165000A
Fits: 1750, 1850, 1950, 1950T,
2050, 1755, 1855, 1955, 2255,
2-85, 2-88, 2-105, 2-110, 2-135,
2-150, 2-155, 2-180, 4-150,
4-175, 4-180

MF Lower Link Swivel Balls



S.01728 - Cat 1
Replaces: MF 886428M1

S.01728 - Cat 1 **2**
S.01730 - Clip **2**

S.01728 - Cat 1 **2**



S.12237

S.04129

2

MF Lower Link Swivel Balls



S.01729 - Cat 2
Replaces: MF 88429M1

S.01729 - Cat 2 **2**
S.01730 - Clip **2**



S.04130

2

2

MF Spring Clip

S.01730
Fits: Most MF Tractors
Replaces: 1869219M1



Lower Link Swivel Balls

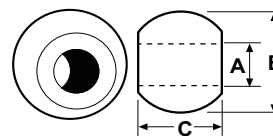

S.01366
(A=7/8", B=1 3/4", C=1 3/8")

S.01369
A=7/8", B=2", C=1 1/2"

S.01367
(A=1", B=2", C=1 1/2")

S.01368
(A=1 1/8", B=2", C=1 1/2")

Cat 1 - Cat 2 Top Link Conversion Bushing

S.00353
(A=2", B=3/4", C=1")

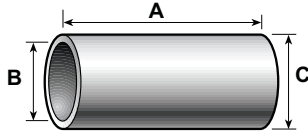

S.00354
(A=13/16", B=3/4", C=1", D=21/32")

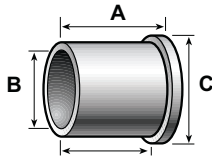

Cat 2 - Cat 3 Top Link Conversion Bushing

S.03008
(A=2", B=1", C=1 1/4")

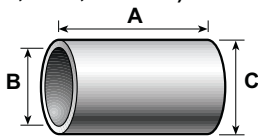

Cat 0 - Cat 1 Lower Link Conversion Bushing

S.00352
(A=1 5/16", B=5/8", C=7/8")

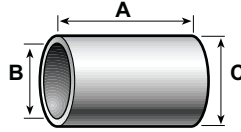

Cat 1 - Cat 2 Lower Link Conversion Bushing

S.00351
(A=1 3/4", B=7/8", C=1 1/8")

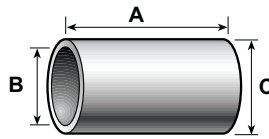

S.33003
(A=2 7/16", B=7/8", C=1 1/8", D=1/2")

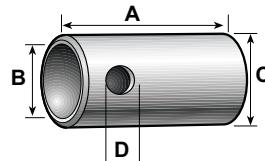

Cat 2 - Cat 3 Lower Link Conversion Bushing

S.03009
(A=1 3/4", B=1 1/8", C=1 7/16")

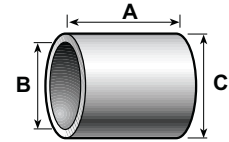

S.00529
(A=2 1/16", B=1 1/8", C=1 7/16")

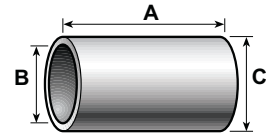

S.03010
(A=2 1/2", B=1 1/8", C=1 7/16", D=15/32")

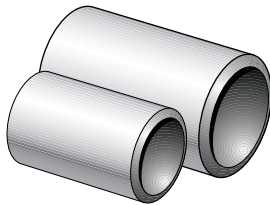
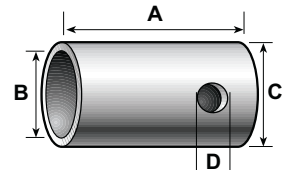

Linkage Bushings

- S.00351 Top Link Cat 1/2
- S.00353 Lower Link Cat 1/2
- S.33003 Quick Release Lower Link Cat 1/2
- S.00529 Lower Link Cat 2/3
- S.03008 Top Link Cat 2/3
- S.03009 Lower Link Cat 2/3
- S.03010 Lower Link Cat 2/3

	S.08485	S.02262	S.04121	S.00360	S.14906
	2 pcs	3 pcs	3 pcs	36 pcs	43 pcs
	2	2	-	24	15
	-	1	-	12	10
	-	-	-	-	2
	-	-	2	-	5
	-	-	1	-	5
	-	-	-	-	2
	-	-	-	-	4

Cat 0 Adjustable Implement Pin

S.03137

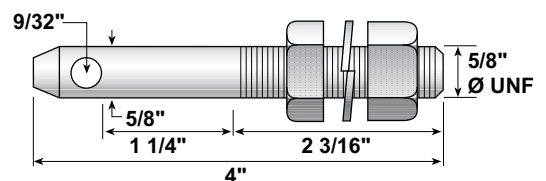

9 3-POINT LINKAGE

Cat 1 - Lower Link Implement Mounting Pins

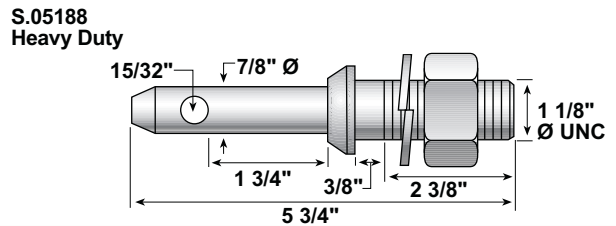
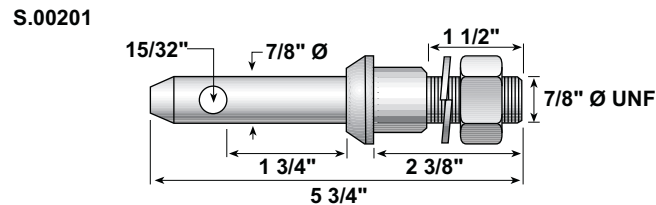
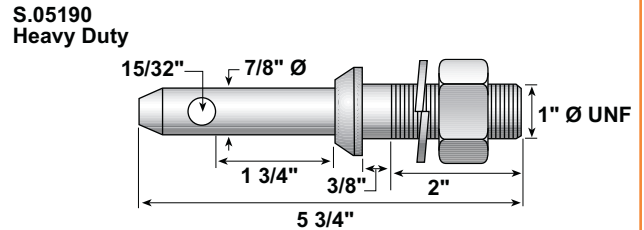
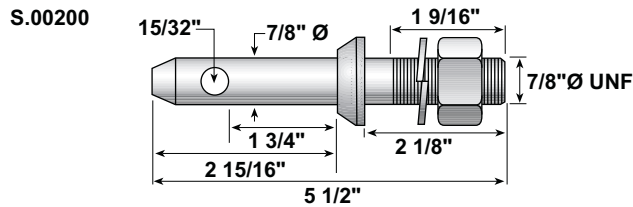
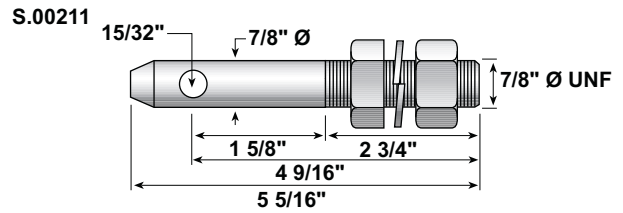
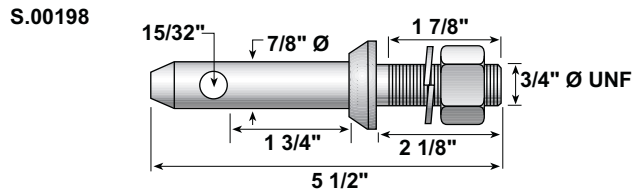
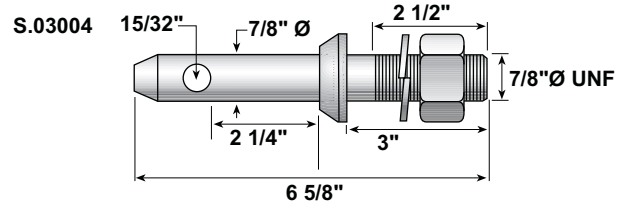
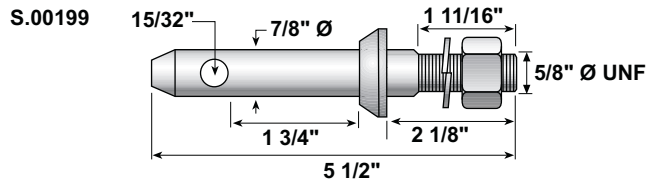

Cat 2 - Lower Link Implement Mounting Pins

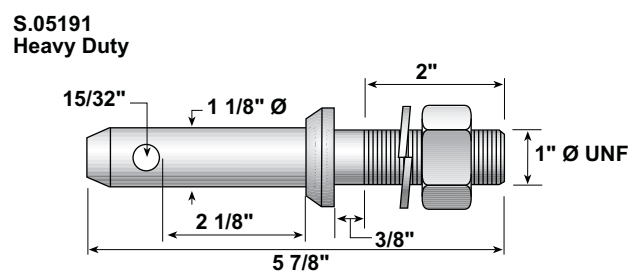
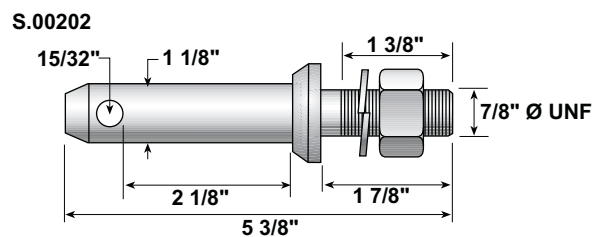
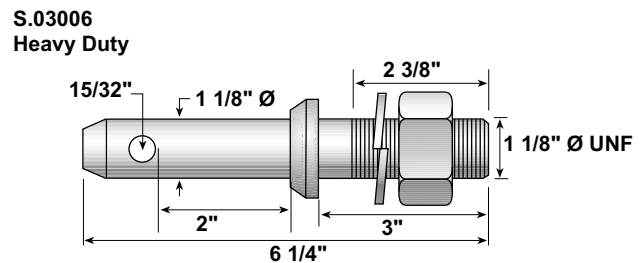
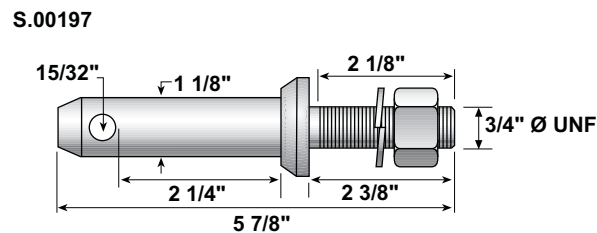

Cat 1-2 Lower Link Implement Mounting Pins

S.00206

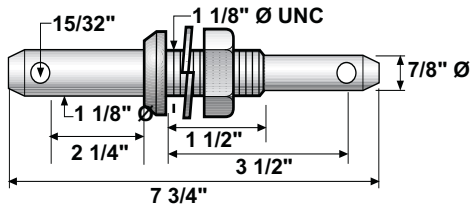

S.00205

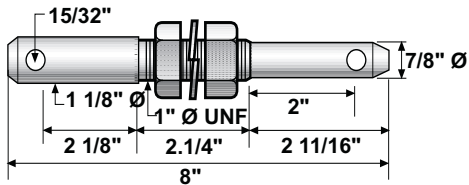

Cat 3 Lower Link Implement Mounting Pins

S.03005

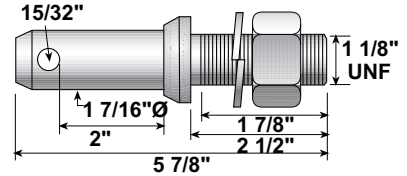

Drawbar Lock w/ Nut & Bolt

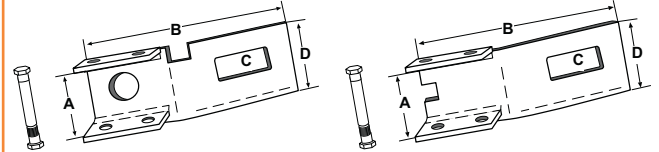

S.22995
(A=3", B=9 1/2",
C=1 3/8"x3", D=3 1/2")
Replaces: DBL2

S.23341
(A=2 1/2", B=8",
C=1 1/4"x2 3/4", D=3")
Replaces: DBL0

Drawbars

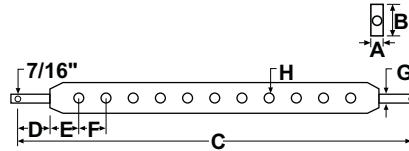
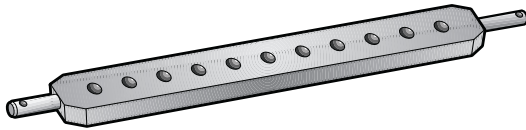

A	B	C	D	E	F	GØ	HØ	No. Holes	Tensile Strength		Cat	Part No.
ins	ins	ins	ins	ins	ins	ins	ins		tons/ins ²	kg/cm ²		
1 7/64	2 3/8	20 1/2	1 15/16	2 1/32	3 5/32	7/8	25/32	5	-	-	1	S.49123
1 3/16	2 3/8	25 1/2	1 15/16	4 29/64	2 1/8	7/8	25/32	7	20	3150	1	S.05009
1 3/16	2 3/8	29 3/4	1 15/16	4 1/2	2 1/8	7/8	25/32	9	20	3150	1	S.00121C
1 3/16	2 1/2	30 1/8	2 1/16	2 3/8	2 1/8	7/8	25/32	11	50	8000	1	S.00125
1 3/16	2 1/2	30 3/4	2 3/8	2 3/8	2 1/8	1 1/8	25/32	11	50	8000	2	S.00126
1 3/16	3 1/8	36 1/4	2	3 35/64	3 1/8	1 1/8	1 19/64	9	20	3150	2	S.15134
1 3/16	2 3/8	39 3/8	2 3/8	7 7/8	3 1/8	1 1/8	1 1/8	7	20	3150	2	S.15081
1 1/4	3	30 3/4	2 3/8	3	2	1 1/8	3/4	11	-	-	2	S.60155
1 1/4	3	36 3/4	2 3/8	4	2	1 1/8	3/4	13	-	-	2	S.60156
1 49/64	3 1/2	42 3/4	2 3/8	5 61/64	4 21/64	1 27/64	1 1/4	7	-	-	3	S.29139

Drawbar Stay Strap

S.60460 - Upper
A=26", B=2 1/2"

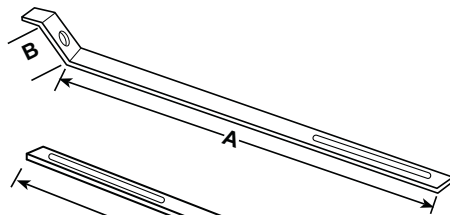

S.60455 - Lower
A=23 3/4", B=2"

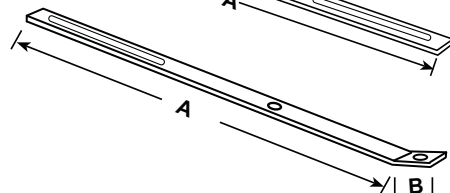

Drawbar Hook

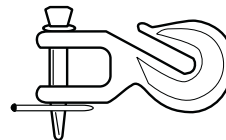

S.52090
Includes 3/4" T-Pin
Use with 5/16"-1/2" chain
Fits: Drawbars up to
1 1/4" Thick

Clevis

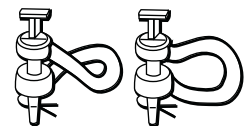

S.61369 - Twist
5/8" Pin, 3/4" Clevis
S.52657 - Twist
3/4" Pin, 7/8" Clevis
S.52656 - Straight
3/4" Pin, 7/8" Clevis

9 3-POINT LINKAGE

Hitch Pins

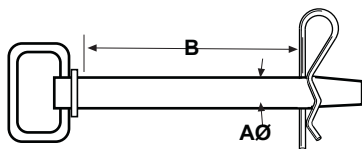

	A	B
S.52093	1/2"	3 1/2"
S.52094	5/8"	4 1/4"
S.52095	5/8"	6 1/4"
S.03015	3/4"	4 1/4"
S.03013	3/4"	6 1/4"
S.03014	7/8"	6 1/4"
S.15165	1"	6 1/4"
S.15201	1"	7 1/4"
S.15167	1 1/8"	6 1/4"
S.15169	1 1/4"	6 1/4"
S.15171	1 1/2"	7 1/4"

Lower Link Pin

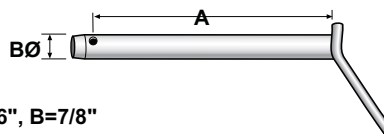

S.08859
A=4 13/16", B=7/8"

Bent Hitch Pin

S.52096
A=3", B=1/2"
S.52097
A=3", B=5/8"
S.52098
A=3 1/2", B=3/4"

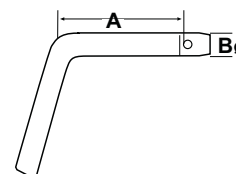

Uni-Link Hitch Pins

S.00366
A=5/8", B=1 1/4", C=2 1/4"
S.00369
A=3/4", B=3", C=4 7/8"
S.00368
A=7/8", B=3", C=4 7/8"
S.00367
A=1", B=3", C=4 7/8"

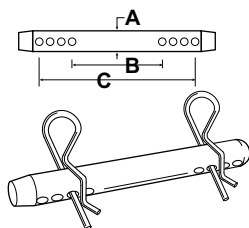

Red Handle Hitch Pins

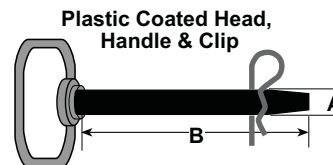

S.52080 A=1/2", B=3 5/8"	S.52085 A=7/8", B=6 1/2"
S.52081 A=5/8", B=4"	S.52086 A=1", B=7 1/2"
S.52082 A=5/8", B=5 1/2"	S.52087 A=1 1/8", B=8 1/2"
S.52083 A=3/4", B=4"	S.52088 A=1 1/4", B=8 1/2"
S.52084 A=3/4", B=6 1/2"	S.52089 A=1 1/2", B=8 1/2"

Hitch Pin

S.61318
A=1", B=3 1/8"

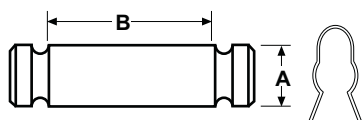

Hitch Pin w/ Chain

S.00408
A=3 7/8", B=3/4"
S.00432
A=7 3/16", B=1"

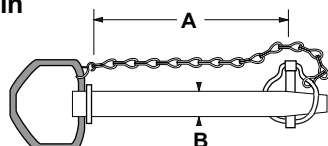

Stabilizer Pins

S.00167
Includes
Lock Nuts
A=3"
B=1"
C=7/16"
D=7/8"Ø

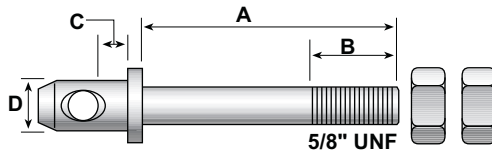

S.00169
A=1 1/4"
B=1 1/8"
C=7/16"
D=7/8"Ø

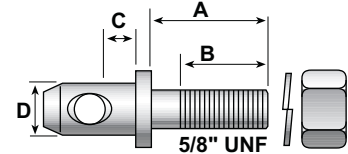

S.00170
Includes Lock
Washer & Nut
A=1 3/8"
B=1 1/8"
C=7/16"
D=3/4"Ø

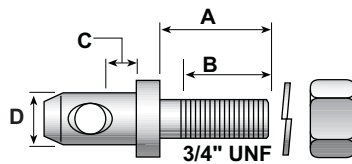

S.00171
A=2 1/2"
B=1"
C=7/16"
D=7/8"Ø

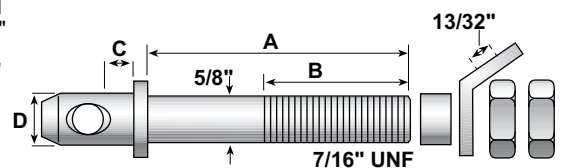

S.01719
Includes
Bushing & Nut
A=1 3/4"
B=7/8"
C=7/16"
D=7/8"Ø

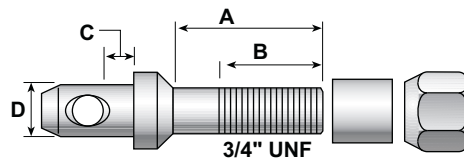

S.03367
A=2 3/8"
B=1 5/8"
C=7/16"
D=7/8"Ø

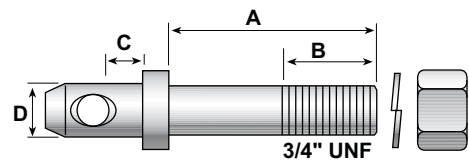

S.03399
Includes Lock
Washer & Nut
A=1 1/2"
B=7/8"
C=1 3/16"
D=3/4"Ø

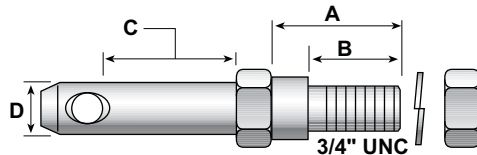

S.66510
A=3 1/8"
B=1"
C=1 1/4"
D=7/8"Ø

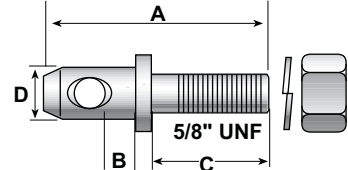

S.00460
Includes Lock
Washer & Nut
A=1 3/8"
B=1"
C=1 3/16"
D=3/4"Ø

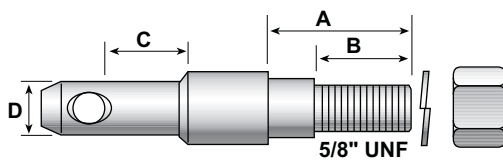

S.60056 - Pin
A=4 3/4"
B=3/8"
C=7/8"
D=7/8"Ø
E=2 1/16"

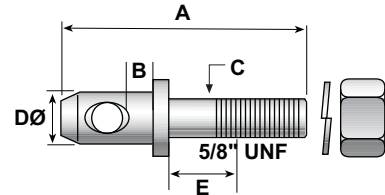

S.01718 - Nut
(Order Separately)

S.03368
A=3"
B=1"
C=7/16"
D=7/8"Ø

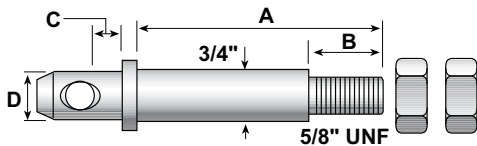

S.05257
A=1 9/16"
B=1 1/16"
C=7/16"
D=7/8"Ø

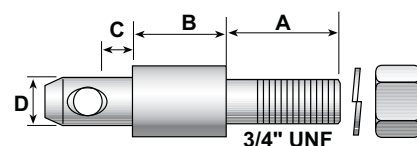

S.03366
A=2 1/4"
B=1 1/16"
C=7/16"
D=7/8"Ø

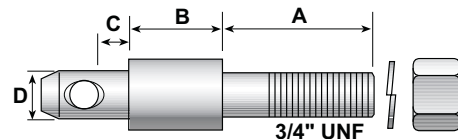

S.75985
A=3 7/16"
B=1/2"
C=1 15/16"
D=7/8"Ø

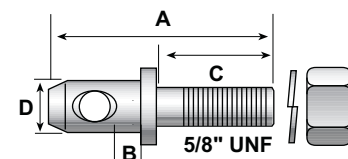

9 3-POINT LINKAGE

Short Stabilizer Bars

S.00185
Red
A=7/8" Pin Hole

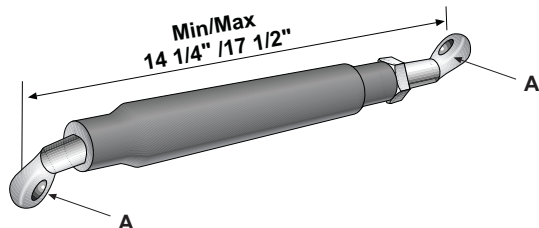

S.00173
A=7/8" Pin Hole

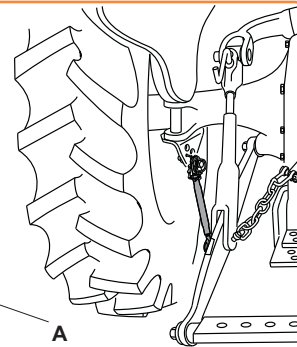
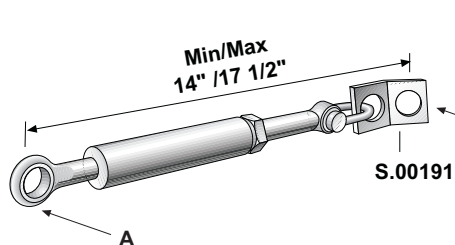

Adjustable Stabilizer Bars

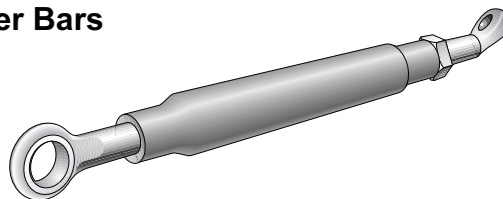
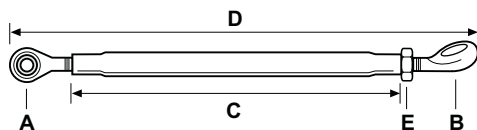
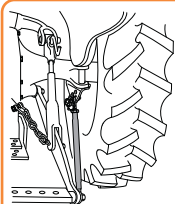

Part No.	AØ ins	C Length ins	C Thread	D Min/Max ins	BØ ins	Color
Standard						
S.00180	3/4	23	3/4"UNC	28 1/2 / 35	7/8	Grey
S.00184	7/8	23	3/4"UNC	28 1/2 / 35	7/8	Red
Heavy Duty						
S.00158	7/8	23	7/8"UNF	28 1/2 / 36	7/8	Zinc
S.03395	7/8	23	7/8"UNF	28 1/2 / 36	7/8	Zinc

Rigid Stabilizer Bars

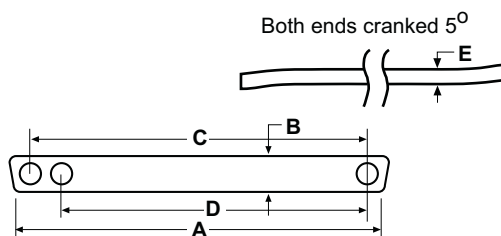
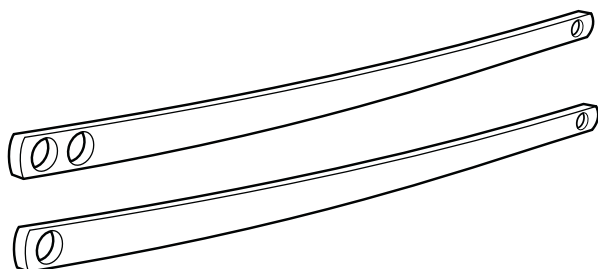

	A ins	B ins	C ins	D ins	E ins	Holes	Replaces
S.00177	33 3/4	1 3/4	31 1/2	-	3/8	2	646102M1
S.00178	34 5/8	1 3/4	32 7/8	31 1/2	3/8	3	
S.61408	34 3/4	1 3/4	33		3/8	2	

Stabilizer Brackets

S.42816
 A=2 1/5"
 B=3 1/2"
 C=6 11/16"
 D=25/64

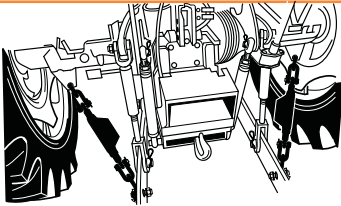
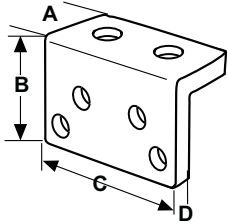

Stabilizer Brackets

S.00160 LH
 S.00161 RH
 A=1 5/16"
 B=2 3/16"
 C=3"
 D=1 5/8"
 E=1 3/4"
 F=2 7/16"

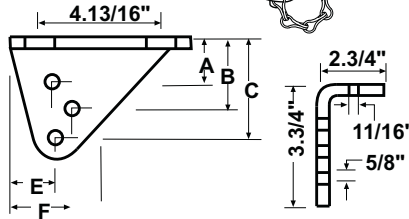
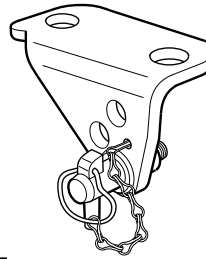

Turnbuckle Assembly

S.05284
 A= 1/2" Pin Holes
 Min=9 1/4 "

S.05258
 A= 1/2" Pin Holes
 Min=10 "

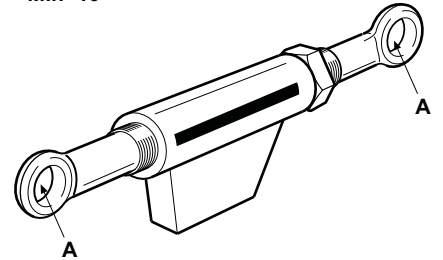

Case/IH Stabilizer Assembly

S.17843
 Min/Max=13 3/4" / 14 15/16"

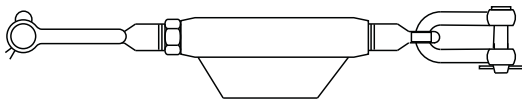

Ford Stabilizer Assembly

S.03315
 Min/Max=15 " / 18 5/8"

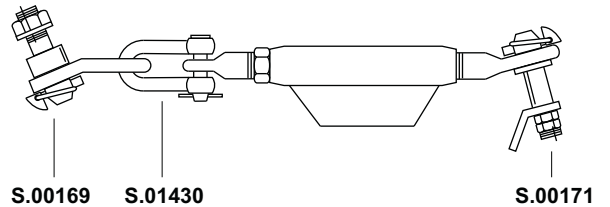

Deutz Stabilizer Assembly

S.03319
 Min/Max=17 1/2" / 21 7/64"

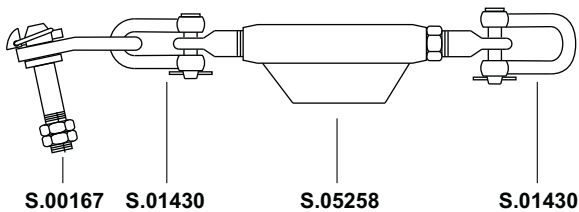

Ford Stabilizer Assembly

S.03284
 Min/Max=19 1/2" / 23 5/32"

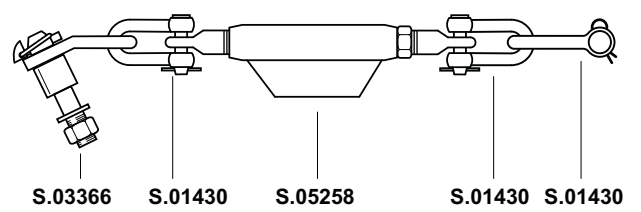

Deutz Stabilizer Assembly

S.03316
 Min/Max=20 1/2" / 23 5/8"

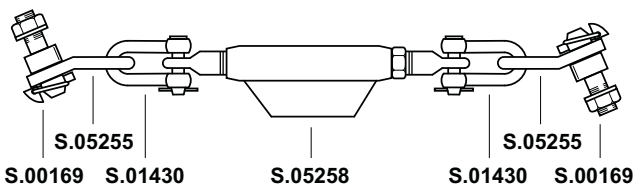

Fiat Stabilizer Assembly

S.03289
 Min/Max=18 7/64" / 21 37/64"

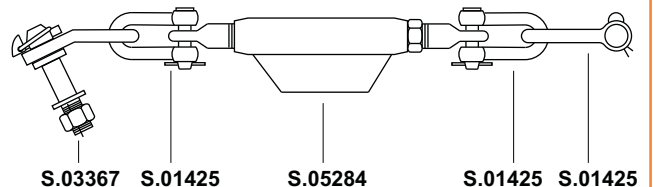

9 3-POINT LINKAGE

Fiat Stabilizer Assembly

S.03290
Min 19 1/2" - Max 23 5/32"

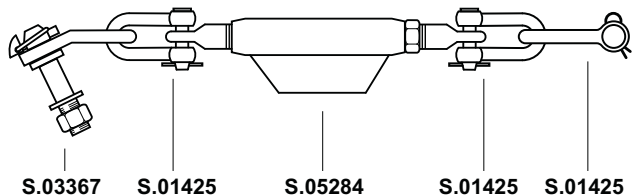

Massey Ferguson Stabilizer Assembly

S.41037
Min 17 1/4" - Max 19 1/2"

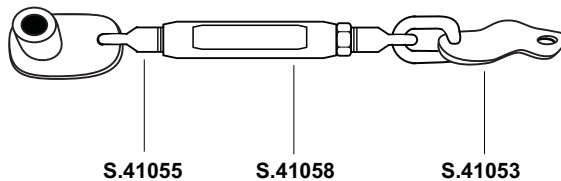

Massey Ferguson Stabilizer Assembly

S.41038
Min 22" - Max 25"

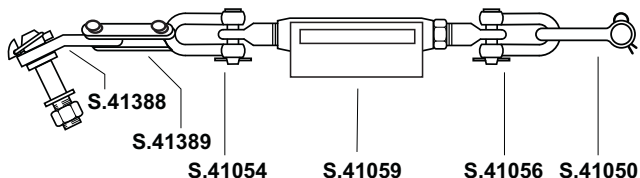

Massey Ferguson Stabilizer Assembly

S.41303
Min 22" - Max 25"

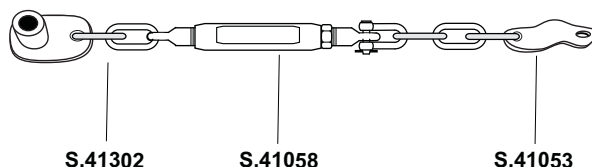

Check Chain Stabilizer

S.00175
A= 7/8" Pin Hole
Min 33" - Max 37"

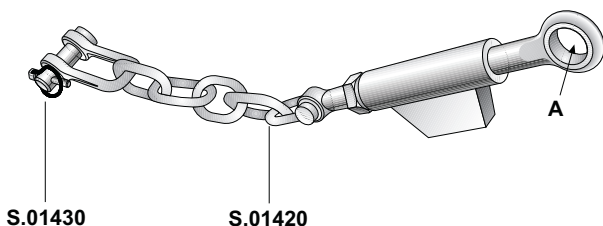

Check Chain Stabilizer

S.00176
A= 7/8" Pin Hole
Min 32 1/4" - Max 36 1/2"

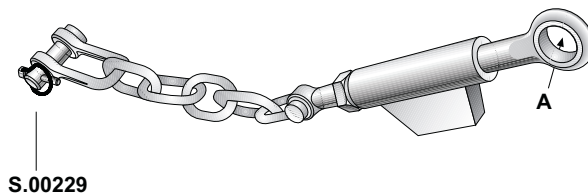

Check Chain Stabilizer

S.05384
A= 7/8" Pin Hole
Min 33" - Max 37"

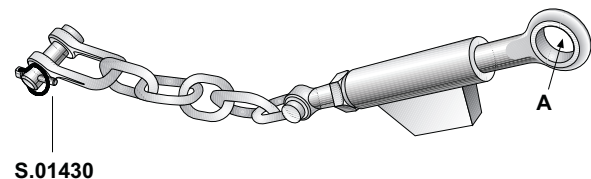

Check Chain Stabilizer

S.05385
A= 7/8" Pin Hole
Min 32 1/4" - Max 36 1/2"

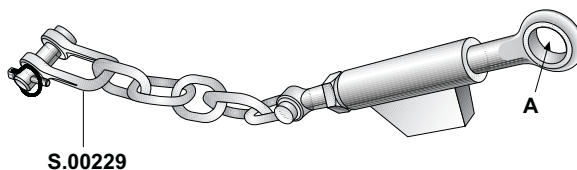

Ford Check Chain Stabilizer Assembly

S.04456
 Min 20 7/64" - Max 22 19/32"
 A=3/4" Bolt End (1 3/4" Useable)
 B=21/32"
 Fits: 4000
 Replaces CFPN-D936-A

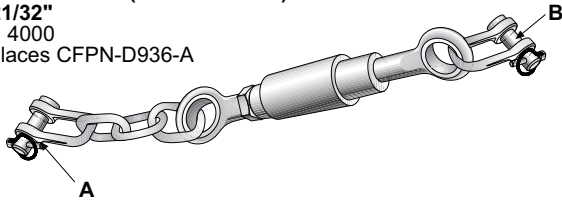

Ford Check Chain Stabilizer Assembly

S.04457
 Min 23 25/64" - Max 25 55/64"
 A=3/4" Bolt End (1 1/16" Useable)
 B=5/8"
 Fits: 5000
 Replaces CFPN-D936-B

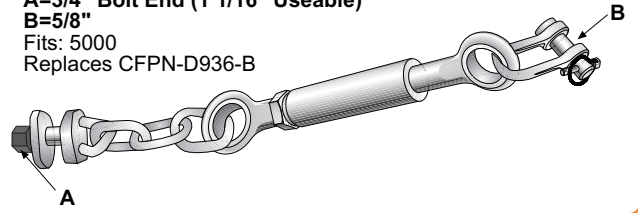

Ford Check Chain Stabilizer Assembly

S.11197
 Min 20 7/64" - Max 22 19/32"
 A=3/4" Bolt End (1 3/4" Useable)
 B=5/8"
 Fits: 4000

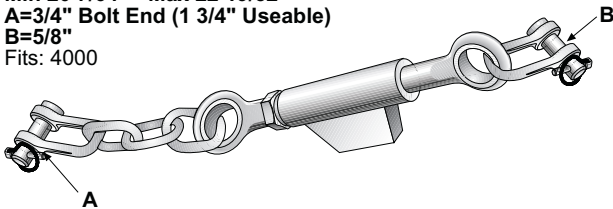

Ford Check Chain Stabilizer Assembly

S.11198
 Min 23 25/64" - Max 25 55/64"
 A=3/4" Bolt End (1 1/16" Useable)
 B=5/8"
 Fits: 5000

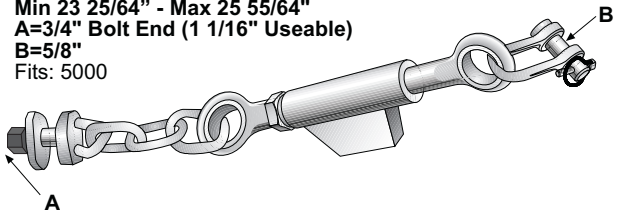

JD Check Chain Stabilizer Assembly

S.08072
 (Non-original type)
 Fits: 2120, 2130, 2140, 3140, 4130

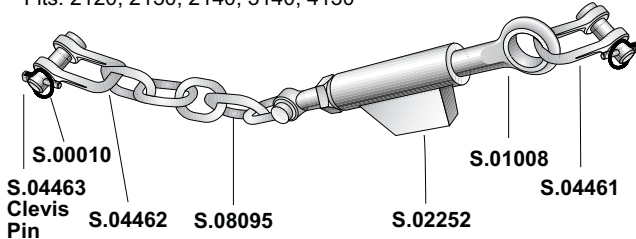

Ford Telescopic Bar Hole Stabilizer

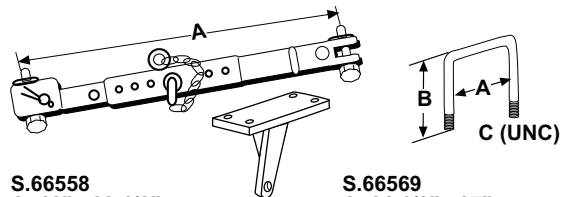

S.66558
 A=18" - 23 1/2"
 Stabilizer Bracket -
 S.66584 - RH
 S.66585 - LH
 S.66582 - U-Bolt
 A=5", B=7 1/2", C=5/8 UNC
 Fits: 3 Cylinder Models

S.66569
 A=21 1/2" - 27"
 Stabilizer Bracket -
 S.66586 - RH
 S.66587 - LH
 S.66583 - U-Bolt
 A=5 1/2", B=8", C=5/8 UNC
 Fits: 4 Cylinder Models (65->)

Telescopic/Threaded Bar Hole Stabilizer

Ford
 S.15609
 Fits: 4000
 S.15610 - RH
 Fits: 5000, 6000, 7000 (w/out Assistor Ram)
 S.15611 - LH
 Fits: 5000, 6000, 7000, 8000 (w/ Assistor Ram)
 MF
 S.15618
 Fits: 265, 275, 290, 565, 575, 590, 675, 690
 Deutz
 S.15745
 Fits: DX80, 85, 90, 110, 3.70, 3.90, 4.50, 4.70

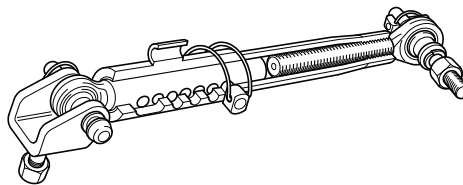

John Deere
 S.15818
 Reversable Link Arms
 S.15819
 Standard Link Arms
 Fits: 1630, 1830, 2030, 2130, 1640, 1840, 2040, 2140, 3040, 3140, 4040, 4240, 4440

Bar Hole Stabilizer Axle Bracket Pin

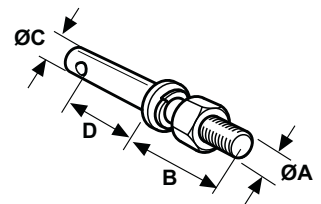

S.15600
 A=3/4"Ø, B=2 1/4",
 C=3/4"Ø, D=1 3/4"
 Fits: S.15609, S.15610,
 S.15611, S.15618, S.15745

9 3-POINT LINKAGE

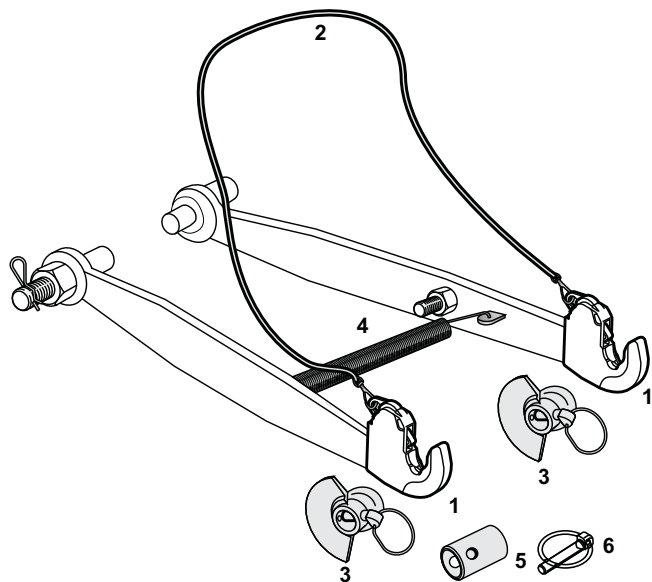

Cat 2 Lower Link Conversion Kit (For Tractors up to 150 HP)

S.33036

Kit Contains:

- 1 **S.33085** x 2 (LH & RH) - 2 Complete Cat 2 Quick Coupling Hooks to be Welded to the Existing Links
- 2 **S.33016** x 1 Control Rope for Lower Links, Complete with 3 Spring Catches
- 3 **S.33000** x 2 - Link Balls (Cat 2) with Guide Cones and King Size Linch Pins
- 4 **S.33015** x 1 - Adjustable Spacer for Lower Link and Arms

Cat 3 Lower Link Conversion Kit (For Tractors up to 280 HP)

S.33037 SPECIAL ORDER ONLY

Kit Contains:

- 1 **S.33051** x 2 (LH & RH) - 2 Complete Cat 3 Quick Coupling Hooks to be welded to the existing links
- 2 **S.33016** x 1 - Control Rope for lower links complete with 3 spring catches
- 3 **S.33002** - Cat 3/3 Lower Link Ball, Guide Cone and Linch Pin Assembly
- 4 **S.33015** x 1 - Adjustable Spacer for lower lifting link
- 5 **S.03010** x 2 - Cat 3/2 Reducing Bushing for lower link ball S.33002



Spacer

S.33011

Cat 2 Spacer for use with S.33005 or S.33006 Ball (2 required)

Replaces
305753

S.33012

Cat 3 Spacer for use with S.33007 Ball (2 required)

305754



Reducing Bushing

S.33003

Cat 2/1 Reducing Bushing for lower link ball S.33000

Replaces
082651

S.03010

Cat 3/2 Reducing Bushing for lower link ball S.33002

305281

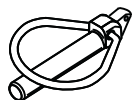

King Size Linch Pin

S.33013

7/16" Linch Pin fitted to Cone Assembly S.33000 & S.33001

Replaces
305855

S.33014

5/8" Linch Pin fitted to Cone Assembly S.33002

305854



Lower Link Ball, Guide Cone & Linch Pin Assembly

S.33000

Cat 2/2 Lower Link Ball, Guide Cone and Linch Pin Assembly

Replaces
099032

S.33001

Cat 3/2 Lower Link Ball, Guide Cone and Linch Pin Assembly

099035

S.33002

Cat 3/3 Lower Link Ball, Guide Cone and Linch Pin Assembly

099034

Lower Link Balls for Q/R Linkage (For use with double plate mounting implements)

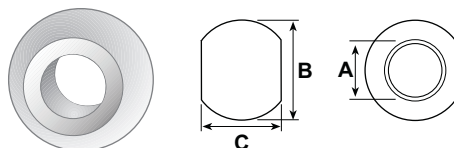

	Cat	Replaces	Dim
S.33005	2/2	099037	A 1 9/64"
		3042429M1	B 2 13/64"
		3617876M1	C 1 49/64"
S.33006	3/2	099039	A 1 9/64"
			B 2 1/2"
			C 1 49/64"
S.33007	3/3	099038	A 1 31/64"
			B 2 1/2"
			C 1 49/64"